

NEW JERSEY FUTURE

REDEVELOPMENT

FORUM 2020

FRIDAY, MARCH 6 / HYATT REGENCY / NEW BRUNSWICK





Founded in 1987, New Jersey Future is a nonprofit, nonpartisan organization that promotes sensible growth, redevelopment and infrastructure investments to foster vibrant cities and towns, protect natural lands and waterways, enhance transportation choices, provide access to safe, affordable and aging-friendly neighborhoods and fuel a strong economy. New Jersey Future does this through original research, innovative policy development, coalition-building, advocacy, and hands-on strategic assistance. Embracing differences and advancing fairness is central to New Jersey Future's mission and operations. To effectively advance its mission, New Jersey Future is firmly committed to pursue a culture of greater justice, equity, diversity, and inclusion through its programs, internal operations and external communications.



Wireless access is available

Network: @Hyatt_Meeting

Username: njforum20

Password: njforum20



#njforum20

@newjerseyfuture

NEW JERSEY FUTURE 16 W. LAFAYETTE STREET | TRENTON, NJ 08608

(609) 393-0008 | NJFUTURE.ORG



WELCOME TO REDEVELOPMENT FORUM 2020!

Redevelopment is both complex and evolutionary. Years ago we focused primarily on revitalization of physical spaces and buildings. But we know today that no project exists in a vacuum. How will a redevelopment project impact a community's health? For whom does it provide opportunity? Will it withstand the impacts of climate change?

Equity, community health, and resilience are integral components of redevelopment planning in 2020 and are deeply embedded in this year's Redevelopment Forum. As you participate today, we encourage you to keep each of these concepts in mind and consider how they can be better incorporated into the redevelopment planning and implementation process.

You will hear from distinguished speakers and panelists today about the connections between climate change, health, and inequity. Our morning plenary focuses on the "culture of health" and how the built environment impacts the health of the people within it. Morning breakout sessions ask how we can use redevelopment to achieve more equitable communities and examine some of the hot issues in redevelopment. Our keynote speaker will discuss climate change and social inequity as future threats critically connected to present-day redevelopment. And afternoon breakouts take a closer look at resilience planning and how government can be a big part of the solution.

New Jersey Future has made it a priority to incorporate today's core concepts into all of our work. From combatting lead in drinking water, to promoting aging-friendly communities, to our input on the State Plan, we aim to create healthy, just, and resilient communities where people want to live and work.

We hope you enjoy this year's Redevelopment Forum and take what you learn back into your communities. It would be wonderful to partner with you through the year in advocating for truly smart growth which incorporates today's big concepts. We look forward to seeing you at the closing reception where we can share ideas. Again, on behalf of all of us at New Jersey Future, welcome!

PETER KASABACH

Executive Director
New Jersey Future





Thanks for making a difference in our community

Bank of America recognizes New Jersey Future. Community leaders like you are a vital resource and inspiration to us all. Thanks to you, progress is being made and our community is becoming a better place to live and work.

Visit us at **bankofamerica.com/newjersey**.

BANK OF AMERICA 

PROGRAM OVERVIEW

TIME	AGENDA	LOCATION
8:00 AM	REGISTRATION and CONTINENTAL BREAKFAST	ATRIUM
8:30 AM	OPENING SESSION <i>Spoken Word Performance</i> ■ PANDORA SCOOTER <i>Welcome</i> ■ PETER REINHART, ESQ. <i>Chair, New Jersey Future Board of Trustees;</i> <i>Director, Kislak Real Estate Institute, Monmouth University</i>	REGENCY BALLROOM
9:00 AM	REMARKS: Catherine McCabe <i>Commissioner, New Jersey Department of Environmental Protection</i>	REGENCY BALLROOM
9:30 AM	PLENARY SESSION <i>Building Healthy Communities</i> ■ STACI BERGER <i>President & CEO, Housing and Community Development Network of New Jersey</i> ■ ADRIENNE HOLLIS, PHD, JD <i>Senior Climate Justice & Health Scientist, Union of Concerned Scientists</i> ■ GIRIDHAR MALLYA <i>Senior Policy Officer, Robert Wood Johnson Foundation</i> ■ NICK SIFUENTES <i>Executive Director, Tri-State Transportation Campaign</i> ■ CHRIS STURM <i>Managing Director, Policy and Water, New Jersey Future</i>	REGENCY BALLROOM
10:30 AM	NETWORKING BREAK	ATRIUM
11:00 AM	MORNING BREAKOUT SESSIONS	BREAKOUT ROOMS
12:30 PM	LUNCHEON <i>Welcome Back</i> ■ PETER KASABACH <i>Executive Director, New Jersey Future</i> Title Sponsors Remarks LUNCHEON KEYNOTE ■ GOV. PARRIS GLENDENING <i>President, Leadership Institute and Governor's Institute on Community Design, Smart Growth America: Former Governor Maryland</i>	REGENCY BALLROOM
2:15 PM	AFTERNOON BREAKOUT SESSIONS	BREAKOUT ROOMS
3:45 PM	CLOSING RECEPTION	ATRIUM

The 2020 Redevelopment Forum has been approved for 5 American Institute of Certified Planners (AICP) Certification Maintenance (CM) credits and 5 CECs for CFMs by the Association of State Floodplain Managers. Individual sessions have been approved for AICP Planning Law credits, Continuing Legal Education (CLE) credits, American Institute of Architects (AIA) LU credits, and Professional Engineers and Land Surveyors CPC credits. Find more information on page 5.



P O W E R I N G P R O G R E S S

EMPOWERING PEOPLE > POWERING LIFE

*Our vision for the future of New Jersey is one where
we use less energy and the energy is cleaner, more
reliable, more resilient and affordable.*



PSEG

We make things work for you.

CONTINUING EDUCATION CREDITS



Certification
Maintenance

The 2020 Redevelopment Forum has been approved for 5 American Institute of Certified Planners (AICP) Certification Maintenance (CM) credits. All sessions qualify for CM credits.

Two sessions have been approved for 1.5 AICP Planning Law Credits: **Getting Incentives Right: The Right Tool for the Right Job** (AM session) and **Stormwater 2020: Smooth Sailing or Choppy Waters?** (PM session)



New Jersey
Builders Association

Two sessions have been approved for New Jersey Continuing Legal Education (CLE) credits, provided by the New Jersey Builders Association (1.8 credits per session). **Please sign in and out at individual sessions to qualify for credits.** The

qualifying sessions are: **Getting Incentives Right: The Right Tool for the Right Job** (AM session) and **Stormwater 2020: Smooth Sailing or Choppy Waters?** (PM session)



Three sessions have been approved for 1.5 American Institute of Architects (AIA) LU credits provided by Preservation New Jersey: **Please sign the form at individual sessions to qualify for credits.**

The qualifying sessions are: **Better Together: Placed-Based Economic Development in Downtowns** (AM session), **Stormwater 2020: Smooth Sailing or Choppy Waters?** (PM session), and **All In: Redevelopment Strategies to Achieve Equity** (AM session).

ENGINEERING CREDITS

Two sessions have been approved for 1.5 Professional Engineers and Land Surveyors CPC credits. **Please sign in and out at individual sessions to qualify for credits.** The qualifying sessions are: **Stronger than the Storm: Building the Infrastructure We Need for a Changing Climate** (PM session) and **Stormwater 2020: Smooth Sailing or Choppy Waters?** (PM session)

FLOODPLAIN MANAGER CREDITS

5 CECs for CFMs by the Association of State Floodplain Managers have been approved for the Redevelopment Forum. All sessions qualify for CEC credits.



*Environmental and Redevelopment Law,
Litigation & Climate Change Resiliency*

150 JOHN F. KENNEDY PARKWAY, SHORT HILLS, NEW JERSEY 07078
(973) 912-9008 • FAX (973) 912-9007 • WWW.MFHLAW.COM

Recognizing the ever-increasing challenges that our local government entities face as the result of extreme climate forces affecting public health, safety and the environment, Maraziti Falcon, LLP has developed a practice area devoted to assisting our clients to increase resiliency and strategically plan for a changing climate.

Extreme weather conditions and excessive regional, local and coastal flooding and storm surges threaten infrastructure, transportation and our clients' ability to protect assets, resulting in a need to adapt governance to meet these challenges and revise existing policies and ordinances to better protect against the adverse effects of these life-altering events.

This practice area complements Maraziti Falcon's existing practice devoted to the counseling of public and private entities regarding environmental, redevelopment, land use law, government, construction law and litigation.



FEATURED SESSIONS

9:00 AM

REGENCY BALLROOM

REMARKS: Commissioner Catherine McCabe New Jersey Department of Environmental Protection

Now is the time for New Jersey to act on climate change. Urgent but thoughtful redevelopment is a core component of NJ PACT – NJ Protecting Against Climate Threats – the state’s regulatory reforms to adapt to unavoidable climate impacts, including sea-level rise. Commissioner Catherine McCabe will address the progress of NJ PACT and other statewide efforts to make New Jersey resilient against climate change – and how everyone in New Jersey plays a vital role in that future.

9:30 AM

REGENCY BALLROOM

MORNING PLENARY: Building Healthy Communities

The plenary will introduce the concept of a “culture of health” and explore the ways in which the built environment impacts the health of the people in it. We’ll hear how we can incorporate a culture of health approach into our redevelopment planning and implementation. Panelists will dissect the culture of health through the lenses of transportation and complete streets, housing options, water infrastructure, lead, and climate change.

- **GIRIDHAR MALLYA** (moderator) *Senior Policy Officer, Robert Wood Johnson Foundation*
- **STACI BERGER** *President & CEO, Housing and Community Development Network of New Jersey*
- **ADRIENNE HOLLIS, PHD, JD** *Senior Climate Justice & Health Scientist, Union of Concerned Scientists*
- **NICK SIFUENTES** *Executive Director, Tri-State Transportation Campaign*
- **CHRIS STURM** *Managing Director, Policy and Water, New Jersey Future*

1:00 PM

REGENCY BALLROOM

LUNCHEON KEYNOTE: Climate Change and Inequity: Today’s Great Threats and the Role of Redevelopment

Parris Glendening, President of Smart Growth America’s Leadership Institute and former governor of Maryland, will discuss two of the biggest threats to our future—climate change and inequity—and how they are critically connected to the issues of land use, housing, and revitalization. These forces of change are just as relevant in New Jersey and Maryland as they are across the country and around the world. We have the tools to address them. We must take action now.

- **GOVERNOR PARRIS GLENDENING** *President, Leadership Institute and Governor’s Institute on Community Design, Smart Growth America*

FEATURED SESSIONS

FLOOR PLAN

LOBBY LEVEL

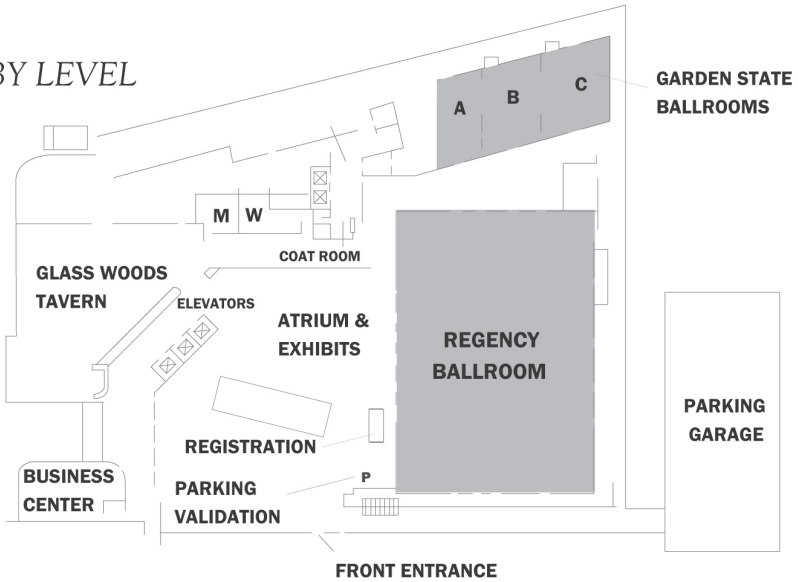

SECOND FLOOR

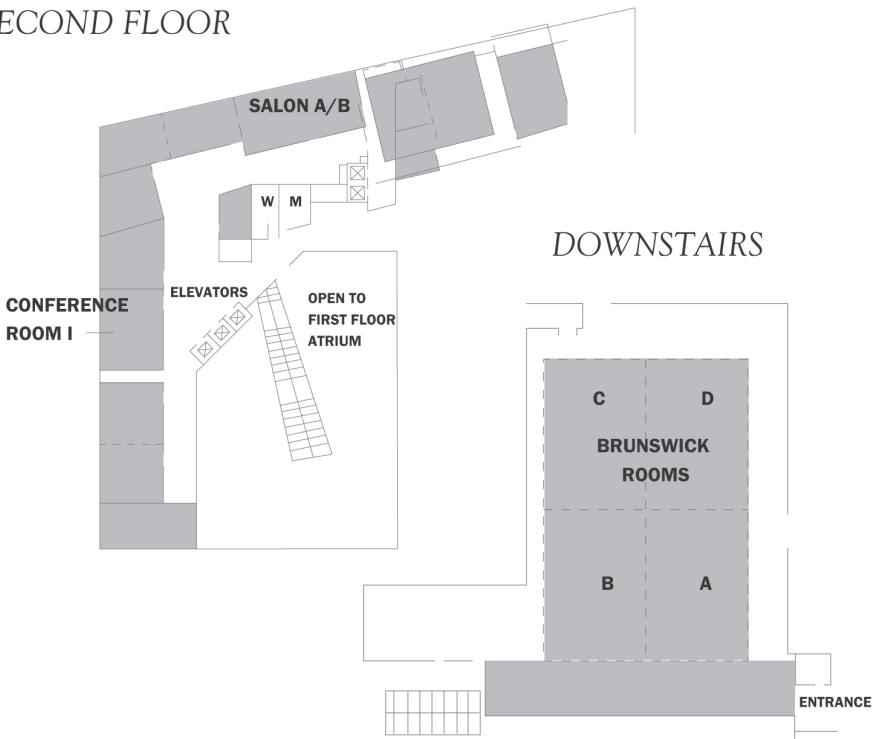

PANELS AT A GLANCE

Detailed descriptions of each panel may be found on pages 11-19.



**EQUITY AND
INCLUSION**



INFRASTRUCTURE



**LEGAL, TECHNICAL
AND FINANCIAL**



**PLANNING AND
DEVELOPMENT**

MORNING BREAKOUT SESSIONS - 11:00 AM

**HERE FOR LIFE:
PLANNING
COMMUNITIES
FOR ALL AGES**

CONFERENCE ROOM I

**GREEN STREETS,
COMPLETE
NEIGHBORHOODS**

GARDEN STATE C

**GETTING INCENTIVES
RIGHT: THE RIGHT
TOOLS FOR THE
RIGHT JOB**

BRUNSWICK A

**EVERYONE'S A CRITIC:
PUBLIC ART'S ROLE
IN REDEVELOPMENT**

GARDEN STATE A

**ALL IN:
REDEVELOPMENT
STRATEGIES TO
ACHIEVE EQUITY**

BRUNSWICK C

**DON'T JUST LEAVE
IT THERE:
ADDRESSING LEAD
IN REDEVELOPMENT**

BRUNSWICK D

**TAYLOR HAM OR PORK
ROLL: DIFFERENT
PERSPECTIVES ON
THE HOT ISSUES IN
REDEVELOPMENT**

SALON A/B

**BETTER TOGETHER:
PLACE-BASED
ECONOMIC
DEVELOPMENT
IN DOWNTOWNS**

BRUNSWICK B

AFTERNOON BREAKOUT SESSIONS - 2:15 PM

**DYNAMIC DUOS:
SOLVING BIG
PROBLEMS WITH
CREATIVE
GOVERNMENT
PARTNERSHIPS**

CONFERENCE ROOM I

**STRONGER THAN
THE STORM:
BUILDING THE
INFRASTRUCTURE
WE NEED FOR A
CHANGING CLIMATE**

BRUNSWICK A

**STORMWATER 2020:
SMOOTH SAILING
OR CHOPPY
WATERS?**

BRUNSWICK B

**BEYOND THE
HORIZON: THE
FUTURE OF THE
STATE PLAN**

BRUNSWICK D

CONFERENCE ROOM I & SALON A/B: *Second Floor*

GARDEN STATE A, B & C: *Lobby Level Outside Regency Ballroom*

BRUNSWICK A, B, C & D: *Downstairs*

**IGNITE!
REDEVELOPMENT**

SALON A/B

5th

Largest
Real Estate
Law Firm
in New York

~The Real Deal (October 2019)

Real estate law demands a multi-disciplinary approach.

- Financing
- Public Finance
- JV & Equity Investments
- Acquisitions & Sales
- Development & Land Use
- Redevelopment
- Construction
- Leasing
- Tax
- Liens & Foreclosures
- Workouts & Restructurings
- Litigation

Please join us in welcoming Isabel D. Chou and Jeet M. Gulati to our Redevelopment Team!



Isabel D. Chou



Jeet M. Gulati

Windels Marx Lane & Mittendorf, LLP | windelsmarx.com | [@WindelsMarx](https://twitter.com/WindelsMarx)

NEW YORK, NY | NEW BRUNSWICK, NJ | MADISON, NJ | STAMFORD, CT

MORNING BREAKOUT SESSIONS

11:00 AM

ALL IN: REDEVELOPMENT STRATEGIES TO ACHIEVE EQUITY

BRUNSWICK C (DOWNSTAIRS)

CREDITS: *Eligible for 1.5 AIA LU credits.
Please sign the form to receive credits.*

One of New Jersey's greatest assets is its diversity. Unfortunately, New Jersey remains an economically and racially segregated state--meaning that not only are some people excluded from opportunity, but also that municipalities are missing out on the economic and social benefits of diversity. How can we use redevelopment as a way to achieve diversity and establish an equitable future where everyone can thrive? This session will explore strategies for incorporating diversity, equity, and inclusion into redevelopment projects, including housing.

- **LESLIE ANDERSON** (*moderator*)
*President & Chief Executive Officer,
New Jersey Redevelopment Authority*
- **PETER BAFITIS**
Managing Principal, RKTB Architects, P.C.
- **REV. ERIC DOBSON**
Deputy Director, Fair Share Housing Center
- **NATASHA ENCARNACION**
*Assistant Director of Programs, New Jersey
Housing & Mortgage Finance Agency*
- **KARIM HUTSON**
Founder & Managing Member, Genesis Companies

HERE FOR LIFE: PLANNING COMMUNITIES FOR ALL AGES

CONFERENCE ROOM I (SECOND FLOOR)

New Jersey's population is aging, and development patterns in New Jersey aren't keeping up with the needs of its growing population of older residents. Highlighting examples of redevelopment projects and aging-friendly planning projects, this session will explore what towns can do to create communities that are better not just for older people, but for everyone. Learn how designing communities for all ages isn't only possible, it's achievable.

- **EMILY GREENFIELD, PHD** (*moderator*)
*Associate Professor, School of Social Work,
Rutgers University*
- **MARYANN BUCCI-CARTER, PP, AICP**
Professional Planner, CME Associates
- **RAMON HACHE**
Mayor, Village of Ridgewood
- **STEPHANIE HUNSINGER**
State Director, AARP New Jersey
- **ISAAC KREMER**
Executive Director, Metuchen Downtown Alliance

MORNING BREAKOUTS

MORE ➔

11:00 AM

GREEN STREETS, COMPLETE NEIGHBORHOODS

GARDEN STATE C (LOBBY LEVEL)

New Jersey Department of Transportation's new model policy and guide puts green streets within reach for all municipalities. Learn how to improve your streets and neighborhoods for safety, equity, health, and stormwater management, all while preserving existing communities.

- **JANNA CHERNETZ, ESQ.** (*moderator*)
*Deputy Director & Director, New Jersey Policy,
Tri-State Transportation Campaign*
- **BARKHA PATEL**
*Director of Transportation Planning,
City of Jersey City*
- **KANDYCE PERRY**
Planning & Policy Manager, New Jersey Future
- **EMILY SCHWENINGER**
*Deputy Director, Thriving Communities,
Smart Growth America*

DON'T JUST LEAVE IT THERE: ADDRESSING LEAD IN REDEVELOPMENT

BRUNSWICK D (DOWNSTAIRS)

News over the past year has exposed how much lead in water, paint, and soil is still a problem in New Jersey, which may pose an obstacle for older municipalities in attracting new economic development and residents. If you are a landlord, developer, or municipal official, here's what you should know about dealing with lead during redevelopment. This session will cover issues of disclosure, transparency, business recruitment, and redevelopment of residential and commercial property.

- **GARY BRUNE** (*moderator*)
Policy Manager, New Jersey Future
- **JOHN BOYD, JR.**
Principal, The Boyd Company Inc.
- **MARJORIE PERRY**
*President & CEO, MZM Construction
and Management*
- **PETER ROSE**
*Managing Director, Community Enterprises,
Isles Inc.*

GETTING INCENTIVES RIGHT: THE RIGHT TOOLS FOR THE RIGHT JOB

BRUNSWICK A (DOWNSTAIRS)

CREDITS: *Eligible for 1.5 AICP Planning Law credits and 1.8 Continuing Legal Education (CLE) credits. Please sign in and out for CLE credits.*

State and local government leaders agree on the importance of economic incentive programs, but incentives to do what, exactly? As the next generation of incentive programs takes shape, this session will focus on what sorts of behavior a well-structured program seeks to elicit from its participants and what we can expect from the state's newest offering.

- **ANNE BABINEAU, ESQ.** (*moderator*)
Partner, Wilentz, Goldman & Spitzer, P.A.
- **AISHA GLOVER**
President & CEO, Newark Alliance
- **W. DAVID HENDERSON, AIA, LEED AP-BD+C**
Principal, HHG Development Associates, LLC
- **TIM SULLIVAN**
Chief Executive Officer, New Jersey Economic Development Authority

TAYLOR HAM OR PORK ROLL: DIFFERENT PERSPECTIVES ON THE HOT ISSUES IN REDEVELOPMENT

SALON A/B (SECOND FLOOR)

Explore controversial redevelopment topics in this new format. Speakers will present on both sides of an issue (for/against) with time for questions from the audience. Audience members will come away with a better understanding of both sides of the argument to better inform their own opinion, particularly on upcoming issues that may require a decision or vote. Topics covered will be short-term rentals, scooters and areas in need of redevelopment.

- **ED DIFIGLIA** (*moderator*)
Program Manager, New Jersey Future
- **ANNISIA CIALONE, PP, AICP, LEED AP**
Director, Department of Housing, Economic Development and Commerce, City of Jersey City
- **BRIAN DEWEY**
Co-Founder & CEO, Koloni Inc.
- **DAVE FRIED**
Mayor, Robbinsville Township
- **WILLIAM GALLMAN, JR.**
Council Member, City of Elizabeth
- **LANCE LANDGRAF, JR.**
Commissioner of Public Works and Construction, Ventnor City
- **ERIKA STAHL, PP / AICP**
Managing Partner, Swick, Stahl & McGurk Planning Associates, LLC

Connell Foley is proud to support



Connell Foley LLP prides itself on the impact our firm has on the development and redevelopment of communities across New Jersey. With the experience and perspective of more than 30 real estate practitioners, we advise on the projects that redefine the state.

For more information, please visit:
www.connellfoley.com

NEW JERSEY | NEW YORK | PENNSYLVANIA



R RUSSO DEVELOPMENT

proudly supports

RUSSO NEW JERSEY FUTURE



Vermella Union Union, NJ

COMMERCIAL - RESIDENTIAL - MISSION CRITICAL

WWW.RUSSODEVELOPMENT.COM

11:00 AM

EVERYONE'S A CRITIC: PUBLIC ART'S ROLE IN REDEVELOPMENT

GARDEN STATE A (LOBBY LEVEL)

Public art is an invaluable tool for thoughtful redevelopment. It can contribute to economic development, safety (painted crosswalks), and placemaking, while respecting a community's history and culture. Unfortunately, it is not without its challenges. These case studies will provide examples of public art projects in redevelopment and complementary art initiatives from different stakeholder perspectives. They will examine the challenges and triumphs faced along the way, including placing public art on public infrastructure.

- **CAROLINE EHRLICH** (*moderator*)
Chief of Staff, Woodbridge Township & Executive Director, Woodbridge Township Redevelopment Agency
- **ELENA CROMEYER, MPH**
Project Director, Transforming Communities Initiative, Trenton Health Team
- **THOMAS GOLETZ**
Vice President, Newark Downtown District
- **LAUREN OTIS**
Executive Director, ArtWorks Trenton

BETTER TOGETHER: PLACE-BASED ECONOMIC DEVELOPMENT IN DOWNTOWNS

BRUNSWICK B (DOWNSTAIRS)

CREDITS: *Eligible for 1.5 AIA LU credits.*
Please sign the form to receive credits.

Downtown redevelopment projects often account for either economic development analysis or place-based planning, but not both. Learn how to incorporate both of these crucial aspects, as well as community engagement, for successful downtown revitalization. For local economic development to be sustainable and welcomed by communities, it must foster healthy, connected communities that maintain a unique sense of place.

- **CHARLES HEYDT, PP, AICP, LEED AP ND** (*moderator*)
Associate Director, Planning Services, Dresdner Robin
- **ADENAH BAYOH**
Founder & CEO, Adenah Bayoh and Companies
- **MARK LOHBAUER**
Principal, JGSC Group, LLC
- **JOSEPH MELE, PE, PLS, PP, LEED-AP, CPESC**
Director of Civil Engineering, Dresdner Robin
- **PATRICK TERBORG**
Founder & Managing Partner, TD+ Partners

MORE ➔

AFTERNOON BREAKOUT SESSIONS

2:15 PM

DYNAMIC DUOS: SOLVING BIG PROBLEMS WITH CREATIVE GOVERNMENT PARTNERSHIPS

CONFERENCE ROOM I (SECOND FLOOR)

How can government agencies and departments establish creative cross-disciplinary partnerships to solve big social problems like homelessness, racial exclusion, and environmental degradation? These case studies will provide examples of how unusual partnerships can create benefits. Examples will include things like hospitals building affordable housing, government partnerships to increase job growth, and creative private/public partnerships for infrastructure financing.

- **ANDY KRICUN** (*moderator*)
Senior Advisor, Moonshot Missions;
Senior Fellow, US Water Alliance
- **SEAN AGID**
Partnership Catalyst, Corvias
- **KATHERINE BRENNAN**
Chief of Staff, New Jersey Housing & Mortgage Finance Agency
- **RONDA URKOWITZ, PP, AICP**
Executive Director, Cross County Connection TMA

STRONGER THAN THE STORM: BUILDING THE INFRASTRUCTURE WE NEED FOR A CHANGING CLIMATE

BRUNSWICK A (DOWNSTAIRS)

CREDITS: *Eligible for 1.5 Professional Engineers and Land Surveyors CPC credits. Please sign in and out to receive credits.*

As our climate changes and storms worsen, much of New Jersey's infrastructure is at risk. How can communities not only make transportation, energy and water systems resilient, but also redesign them to take advantage of new technologies and changing community needs? This session will explore ways to harness regulations, integrated solutions and stakeholder input to build climate-ready and future-ready infrastructure.

- **NIEK VERAART** (*moderator*)
Senior Vice President and National Practice Lead - Planning, Michael Baker International, Inc.
- **GARLEN CAPITA**
Senior Associate/Urban Designer, WRT
- **SEAN MORIARTY, ESQ.**
Chief Advisor for Regulatory Affairs, New Jersey Department of Environmental Protection
- **ANDREW SALKIN**
Founding Principal, Resilient Cities Catalyst

STORMWATER 2020: SMOOTH SAILING OR CHOPPY WATERS?

BRUNSWICK B (DOWNSTAIRS)

CREDITS: Eligible for 1.5 Professional Engineers and Land Surveyors (PELC) CPC credits, 1.5 AIA LU credits, 1.5 AICP Planning Law credits, and 1.8 Continuing Legal Education (CLE) credits. Please sign in and out to receive PELC CPC credits, AIA LU credits, and CLE credits.

2020 brings changes to New Jersey's stormwater management seascape. New Jersey Department of Environmental Protection is publishing important amendments to the stormwater rules and further amendments are in the works. State legislation now allows the creation of stormwater utilities, through which municipalities can create a stable funding source for critical infrastructure improvements and maintenance. Looming over it all? Climate change and the massive challenges it presents. Learn about new stormwater requirements and opportunities, and how you can use them to improve communities.

- **ERIN LAW, ESQ.** (*moderator*)
Partner, McManimon, Scotland & Baumann, LLC
- **MICHELE ADAMS, PE**
Founder & Principal, Meliora Designs
- **TAVIS DOCKWILLER**
Founder & Principal, Viridian Landscape Studio
- **ELENI GIANNIKOPOULOS, PE**
Client Manager/Project Coordinator, Suburban Consulting Engineers
- **GABRIEL MAHON, PE**
Chief, Bureau of Nonpoint Source Pollution, New Jersey Department of Environmental Protection

BEYOND THE HORIZON: THE FUTURE OF THE STATE PLAN

BRUNSWICK D (DOWNSTAIRS)

New Jersey hasn't updated its state plan in almost two decades, but the reinvigorated State Planning Commission points toward progress. What are the latest updates on state planning, and how should the next iteration of the state plan account for climate change and other planning challenges? Join us for this unique roundtable format where participants will work through real challenges in real time and the audience gets to participate.

- **EDWARD MCKENNA, ESQ.** (*co-moderator*)
Senior Partner, McKenna, DuPont, Higgins & Stone
- **DONNA RENDEIRO** (*co-moderator*)
Executive Director, New Jersey Office of Planning Advocacy
- **MICHELE BYERS**
Executive Director, New Jersey Conservation Foundation
- **DANIELLE ESSER**
Director of Governance & Strategic Initiatives, New Jersey Economic Development Authority
- **BRUCE HARRIS**
Commissioner, New Jersey State Planning Commission
- **DAN KENNEDY, PP/AICP, MCRP**
Director of Environmental & Utility Operations, Utility and Transportation Contractors Association of New Jersey
- **WALTER LANE**
Director of Planning, Somerset County
- **LIZ SEMPLE**
Senior Planning Advisor, New Jersey Department of Environmental Protection

MORE ➔

**Question the norm.
Design with passion.
Build what's next.**



Camden Waterfront Redevelopment
Rendering Courtesy of Robert A.M. Stern Architects



PARTNERS FOR WHAT'S POSSIBLE | www.pennoni.com

Civil/Site Design • Construction Engineering • Environmental • Geotechnical • LA/Planning • MEP • Materials Inspection & Testing
Structural • Survey & Geospatial • Technology Solutions • Transportation • Water Resources • Water/Wastewater



2:15 PM

IGNITE! REDEVELOPMENT

SALON A/B (SECOND FLOOR)

This collection of rapid-fire presentations will present a wide variety of topics in redevelopment, sparking ideas and inspiration.

■ **ROB BECKELMAN, ESQ.**

Shareholder, Wilentz, Goldman & Spitzer, P.A.

WAVE OF REDEVELOPMENT TRANSFORMS LONG BRANCH OCEANFRONT■ **NEIL CHAMBERS**

Founder & CEO, Chambers Design

LANDSCAPE DESIGN FOR REDEVELOPMENT SUCCESS■ **TAI COOPER**

Vice President, Policy & Communications, New Jersey Economic Development Authority

STOP, COLLABORATE AND LISTEN!■ **JULIA FAHL**

Mayor, City of Lambertville; Vice President, Legislative Affairs, Tonio Burgos and Associates

COMMUNITY DEVELOPMENT: GETTING BUY-IN BY REACHING OUT■ **KATHLEEN FOLEY**

Compliance Investigator and Field Quality Assurance Coordinator, USEPA Region 2 Monitoring & Assessment Branch

REDUCING LANDFILLS THROUGH COOPERATIVE REUSE■ **ALLEN KRATZ**

Principal, Resilience Works, LLC

AND

EMILY JABBOUR

Council Member, City of Hoboken

SEA LEVEL RISE: WHO PAYS AND HOW?■ **BILL LINDNER**

*Administrator, Office of Brownfield and Community Revitalization,
New Jersey Department of Environmental Protection*

PATHWAYS TO PROGRESS IN PERTH AMBOY■ **STEVEN MLENAK, ESQ.**

Partner, Greenbaum, Rowe, Smith & Davis LLP

UNDERSTANDING NEW JERSEY'S NEW LAND BANK LAW■ **BRAD MOLOTSKY, ESQ.**

Partner, Duane Morris LLP

OPPORTUNITY ZONES: ARE THEY REAL OPPORTUNITY ZONES OR FOOL'S GOLD?■ **JACK PARUTA AIA, LEED AP BD+C**

Senior Project Architect, Gensler

ADAPTIVE REUSE: NEW LIVES FOR OLD BUILDINGS■ **MICHAEL STATON**

Vice President, CPC Mortgage Company, a subsidiary of The Community Preservation Corporation

PARTNERSHIPS, PRODUCTS, AND PERSEVERANCE: REFINANCING AND PRESERVING AFFORDABLE SENIOR HOUSING

ART AT THE REDEVELOPMENT FORUM

Redevelopment is, ultimately, about people and places. Vibrant communities are the collective expression of people living in a common place, and art is one way this expression manifests itself. Today's featured artist will inspire us to reflect on both the personal and universal aspects of place—on how much place matters to each of us, and what it means to share both a community and the place that is New Jersey.



PANDORA SCOOTER

Pandora Scooter is a nationally recognized spoken word artist who has toured the US twice with her solo shows. Currently, she teaches acting at NYU and other theatre-related courses at Terry Knickerbocker Studio and her own boutique acting company, Working Actors Studio. She has performed in NYC, Philly, New Haven, Newark, Jersey City, Washington DC, Dallas, Jackson, Nashville, Houston, Austin, Topeka, among many other cities. Her newest play, *Masks*, is under option for production. She is a graduate of Mason Gross School of the Arts and has lived in Highland Park for 28 years.

On the 25th Anniversary of the 10 Most Endangered Historic Places in New Jersey, *SAVED OR LOST FOREVER* tells the story of places that bore witness to significant events and periods in NJ history, and their importance to the communities that cherish these pieces of our collective past. Each year, we lose tangible connections to the past through the neglect and demolition of historic structures. PNJ's 10 Most Endangered Historic Places in NJ list draws attention to the most threatened of these places. *SAVED OR LOST FOREVER* connects viewers to the story of three sites recognized on the list over the years – Camden High School, Romer Shoal Light, and the Van Wagenen/



Apple Tree House.

The 10 Most documentary was made possible through a project grant from the New Jersey Historical Commission, a division of the Department of State.

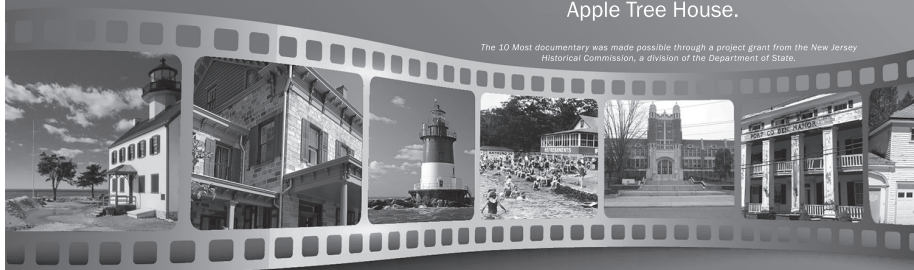

PRESERVATION
new jersey

Watch the documentary at:
www.preservationnj.org

SPEAKER BIOGRAPHIES

MICHELE ADAMS, PE

Founder and Principal, Meliora Design

Michele Adams is a water resources engineer whose work focuses on sustainability, green infrastructure, and engineering designs informed by ecology. She was one of the authors of the Pennsylvania Stormwater Manual as well as NYC Parks' High Performance Landscape Guidelines, and served for six years on the USGBC Sustainable Sites Committee, including developing LEED V4 criteria. Recent projects include the Philadelphia Children's Zoo, Shoemaker Plaza at the University of Pennsylvania, the Stroud Water Research Environmental Education Center, and the Meadow Expansion at Longwood Gardens.

SEAN AGID

Partnership Catalyst, Corvias

Sean works collaboratively with the nation's most progressive municipal, military and higher education leaders to create and implement innovative solutions. He structures long-term real estate and infrastructure partnership transactions with governments and large institutions to deliver solutions in the areas of water, renewables, housing and utilities. Sean led the financial effort for a \$53 million partnership with the Stormwater Authority of Chester, Pennsylvania and led the financial structuring of the \$110 million second phase of the Clean Water Partnership with Prince George's County, Maryland. He graduated from Georgetown University in 2018 with an M.P.S. in Real Estate Finance. He has a B.S. in Business Administration from the University of Rhode Island.

LESLIE ANDERSON

*President & Chief Executive Officer,
New Jersey Redevelopment Authority*

Leslie Anderson leads the New Jersey Redevelopment Authority, a multi-million dollar independent financing authority created by the state of New Jersey to transform urban

communities through direct investment and technical support. Leslie is the first African American woman to helm an independent financing authority in New Jersey and has been reappointed to this position by three consecutive governors. Under her bold leadership, NJRA has used its financial resources to leverage over \$3.8 billion in new investments, helping to redevelop some of New Jersey's most economically challenged neighborhoods. Moreover, the authority committed \$418 million in direct investments in 44 eligible communities. This has led to the creation of 15,000 new housing units and 10 million square feet of commercial and retail space.

ANNE BABINEAU, ESQ.

Partner, Wilentz, Goldman & Spitzer, P.A.

Anne Babineau leads the statewide multi-disciplinary redevelopment practice at Wilentz, Goldman & Spitzer. She has worked with clients undertaking redevelopment projects throughout New Jersey and has been involved in projects at all stages from redevelopment area designation through project completion, counseling clients on redevelopment plans, designation of redevelopment areas, property acquisition and government approvals. She has negotiated and drafted contracts between developers and public entities for implementation of redevelopment, tax abatement, financing documents, and loan and grant agreements, and has handled litigation and appeals in federal and state courts.

PETER BAFITIS, AIA

Managing Principal, RKT Architects, P.C.

Peter Bafitis, AIA, has over thirty years of experience in the design and construction of a diverse range of projects including multifamily housing, schools, hospitals, transportation projects, adaptive reuse, and large-scale urban design work. Peter has focused his career on strengthening the urban environment by reinforcing the social institutions that sustain it, a focus centered on neighborhood preservation achieved

primarily through the design and integration of affordable housing, K-12 schools, and transportation facilities. As managing principal at RKT Architects, he has directed some of the firm's largest projects for both public and private clients, advancing the firm's already recognized expertise in multifamily housing and adaptive re-use. Peter currently serves as co-chairman of the AIA NY Chapter Housing Committee.

ADENAH BAYOH

Founder & CEO, Adenah Bayoh and Companies

At age 13, Adenah escaped the civil war in her native country of Liberia, immigrated to the United States and is now one of the most successful restaurant and real estate development entrepreneurs in her home state of New Jersey. Adenah is the founder and CEO of Adenah Bayoh and Companies, which is the parent corporation that owns IHOP franchises across the state and a real estate development portfolio with several major residential and commercial urban redevelopment projects across northern New Jersey. In 2017, Adenah launched her own signature fast casual, farm-to-table, soul food restaurant, Cornbread, which she co-founded with Zadie B. Smith in Maplewood. In 2019, through a landmark partnership with Walmart, the restaurant chain expanded to Pennsylvania, and in Spring of 2020, will open a second location in Newark.

ROB BECKELMAN, ESQ.

Shareholder, Wilentz, Goldman & Spitzer, P.A.

Robert Beckelman is a shareholder at Wilentz, Goldman & Spitzer, P.A. concentrating his practice in redevelopment, land use and zoning, affordable housing, and related litigation. Robert represents real estate developers and property owners in connection with land use and zoning matters and disputes as well as municipalities as special redevelopment, housing or litigation counsel. His experience also encompasses code enforcement issues, local government laws, procurement, public bidding and contracts, elections and lobbying laws, Tidelands and CAFRA issues, and municipal court matters. Robert has been distinguished with

a Martindale-Hubbell AV Preeminent Peer Review Rating, has been named to the Best Lawyers in America list in Real Estate Law since 2013, and in 2018 was named to the NJBIZ "Leader in Law" list.

STACI BERGER

President & CEO, Housing and Community Development Network of New Jersey

Staci Berger has been the President and CEO of the Housing and Community Development Network of New Jersey since 2013. In this role, she directs the statewide association of more than 250 community developers and private sector stakeholders to enhance efforts to create affordable homes and revitalize communities, and to improve the climate for community development in New Jersey. She has made multiple appearances on national media outlets, including MSNBC, NPR, *The New York Times* and *The Wall Street Journal*, and is a recognized expert on housing and community development issues sought by national, regional and local press. She received her Masters of Public Affairs and Politics from Rutgers University in 2004.

JOHN BOYD, JR.

Principal, The Boyd Company Inc.

Since joining the Boyd Company in 2002, John Boyd, Jr. has worked on site selection projects that produced billions in capital investment and thousands of new jobs in the U.S., Canada, and offshore. John is a popular keynote speaker at conferences on corporate relocation, economic development, and commercial real estate development. He has addressed numerous forums, including those sponsored by Nasdaq, Miami Herald CEO Council, Rhode Island Infrastructure Bank, American Cities Business Journals, and the Las Vegas Global Economic Alliance. In 2019, John was invited by Governor Phil Murphy's Incentive Task Force to deliver expert testimony on the use of tax incentives to attract new industry. John's expert perspectives are routinely featured in the news media, including the Wall Street Journal, Fortune, Forbes, and others.



IS PROUD TO SUPPORT
NEW JERSEY FUTURE
AND THE 2020
REDEVELOPMENT FORUM

609.924.9775 | BLSSTRATEGIES.COM

KATHERINE BRENNAN

Chief of Staff, New Jersey Housing & Mortgage Finance Agency

Katherine joined the Agency as Chief of Staff in February 2018. As Chief of Staff, Katherine works across Agency departments to lead implementation of strategic initiatives and policy goals. Most recently, this work has centered on addressing health equity through housing and community development; including the first-in-the-nation statewide hospital and housing partnership. Katherine served on Governor Murphy's Economic Working Group and as the Deputy Policy Director for the Housing Transition Committee. She is honored to currently serve on the boards of The Waterfront Project, NOW NJ, New Leaders Council New Jersey, and the Van Vorst Park Neighborhood Association. Katherine has a B.A. from Xavier University and a Master of City and Regional Planning degree from the Rutgers Bloustein School of Planning and Public Policy.

GARY BRUNE

Policy Manager, New Jersey Future

Gary Brune's primary focus areas at New Jersey Future are stormwater utilities and lead in drinking water, with ancillary work on energy issues and water financing policy. Prior to joining New Jersey Future, Gary was the chief financial officer at the New Jersey Department of Transportation. He also served as the executive director of the Transportation Trust Fund, developing policy options for program reauthorization. Prior to DOT, Gary worked at the New Jersey Office of Management and Budget, rising to the position of associate director. At OMB, he was responsible for developing budget recommendations for transportation, environmental protection, and capital/infrastructure, among other areas. During this time, Gary also served on the New Jersey Commission on Capital Budgeting and Planning. Gary received a Bachelor of Arts in History from the

University of Dayton in Ohio and Master's in Public Administration from Baruch College, City University of New York.

MARYANN BUCCI-CARTER, PP, AICP

Professional Planner, CME Associates

Maryann has a Master's in City and Regional Planning and 29 years of diverse experience in private and public practice specializing in the areas of land use planning, redevelopment, affordable housing, mixed-use residential and neighborhood design projects. In professional practice she has focused on improving the quality of life of community residents through strategic design and management involving site planning, redevelopment tools, strategic master planning, and transit-oriented design. Maryann is currently a Project Leader with CME Associates providing municipal planning services throughout New Jersey and an adjunct professor of Urban Planning at the Rutgers University Edward J. Bloustein School of Planning and Public Policy.

MICHELE BYERS

Executive Director, New Jersey Conservation Foundation

Michele joined New Jersey Conservation Foundation in 1982 and became the Executive Director in 1999. She is an advisor to the Hunterdon Land Trust, on the board of the New Jersey League of Conservation Voters, and President of RethinkEnergyNJ.com. In 1995 Michele was appointed by Governor Whitman to the State Planning Commission and was named Vice Chair in 1998. She has served as Chair of New Jersey State Committee of the Highlands Coalition, Chair of New Jersey's Freshwater Wetlands Mitigation Council, a member of the New Jersey State Trail Council, and Vice Chair of the New Jersey Highlands Coalition. In 2003, Michele was appointed by Governor McGreevey to the Highlands Task Force. Michele has a B.A. in Biology, Western State College, Gunnison, Colorado.



ATLANTIC BUILDERS CONVENTION

Hosted by New Jersey Builders Association

CONNECT.

LEARN.

GROW.

CONNECT: 6,000+ building industry professionals

LEARN: Attend educational and accredited courses

GROW: Expand your business with this networking opportunity

March 31 - April 2, 2020

Atlantic City, NJ

Sales & Marketing (SAM) Awards - March 31

Conference & Expo - April 1 & 2

ABConvention.com

GARLEN CAPITA

Senior Associate/Urban Designer, WRT

Trained as an urban designer and landscape designer, Garlen has over 21 years of experience represented by large scale urban design and planning projects, as well as detailed site plans for a range of project types including urban neighborhoods, parks, streetscapes, commercial corridors, and civic facilities. Her belief that successful projects use a multi-disciplinary approach that builds on the distinctive attributes of the natural and man-made setting leads her to designs that are community-driven and create an enduring sense of place. Her recent work at WRT has been in urban revitalization in Philadelphia and Camden, where she is engaged in the local communities to build capacity for improved housing, community health, and neighborhood resilience.

NEIL CHAMBERS

Founder & CEO, Chambers Design

Neil Chambers is co-founder of Chambers Design, an award winning landscape design/build studio based in South Orange, NJ. The studio focuses on creating contemporary, sustainable exterior spaces with a mix of project types from residential homes, placemaking, public spaces, urban design, green infrastructure, and ecological restoration. As a design and build company, equal effort is given to the production of pre-construction phases as well as installation. Neil's work has been showcased in *Grist*, *Vogue Italia*, *Architectural Record*, *Civil Engineering*, *Metropolis Magazine*, *BBC*, *Economist*, *Huffington Post*, and *The Village Green of Maplewood & South Orange*. His design process aims to break away from standard ways of thinking about outdoor spaces, and instead implement sustainable and innovative solutions that feel elegant, authentic, and refreshing.

JANNA CHERNETZ, ESQ.

Deputy Director & Director, New Jersey Policy, Tri-State Transportation Campaign (TSTC)

Janna Chernetz joined TSTC in 2011. As TSTC's Director of New Jersey Policy, Janna focuses on issues related to sustainable funding of the New Jersey Transportation Trust Fund and the state budget, responsible transportation spending and investment decisions, pedestrian and bicycle safety, and enhancing economic development through the connection of land use and transportation. While at TSTC, Janna led a successful campaign to include bike accommodations on the entire 12.5 mile New Jersey Department of Transportation rebuild of Route 35 in Ocean County, serving as a national example of how Complete Streets can be implemented. Janna played an integral role in the creation of the 2014 NJDOT's Pedestrian Safety Action Plan and currently serves as an Executive Council member of New Jersey's Bicycle and Pedestrian Advisory Committee.

ANNISIA CIALONE, PP, AICP, LEED AP

Director, Department of Housing, Economic Development and Commerce, City of Jersey City

Annisia Cialone serves as the Director of the Department of Housing, Economic Development and Commerce (HEDC) for the City of Jersey City. The Department includes the Divisions of Economic Development, City Planning, Construction Code, Zoning, Community Development, Housing Preservation, and Commerce. Prior to her appointment as the Director of HEDC, she served as the Director of the Division of City Planning. She has expertise in the management and design of large-scale urban design and strategic master planning projects for both public and private clients. Annisia holds a Bachelor of Architecture from The Cooper Union and a Master of Architecture in Urban Design from Harvard University's Graduate School of Design.

TAI COOPER

*Vice President, Policy & Communications,
New Jersey Economic Development Authority*

As Vice President for Policy & Communications at the NJEDA, Tai is responsible for leading the NJEDA's communications and enhanced engagement strategy. This includes strengthening ties with policy-makers at the federal, state, and local level as they look to advance strategies, research and data that will help drive equitable and inclusive economic development policies and programs. Prior to joining the NJEDA, she was the Deputy Chief Policy Advisor to Governor Murphy and led New Jersey's Federal Opportunity Zone initiative. A Newark resident, Tai earned a Bachelor of Arts Degree in Urban Planning from The Edward J. Bloustein School of Planning and Public Policy at Rutgers University and a Master's Degree in urban planning from the Robert F. Wagner School of Public Service at New York University.

ELENA CROMEYER, MPH

*Project Director, Transforming
Communities Initiative, Trenton Health Team*

Elena joined Trenton Health Team in June 2016 as Project Director of the Transforming Communities Initiative—a program designed to address policy, systems, and environmental issues that affect health at the population level, including promoting breastfeeding enhancement policies, nutrition and physical fitness among school-aged children and youth, Tobacco 21 and Complete Streets. She also oversees a new Robert Wood Johnson Foundation mobile health clinic demonstration project, which brings primary care to underserved residents of Trenton. Elena earned her Bachelor of Arts, with a double major in Letters and Spanish, from the University of Oklahoma and a Master of Public Health in international community health from New York University. Elena is bilingual in English and Spanish and speaks Italian fluently.

BRIAN DEWEY

Co-Founder & CEO, Koloni, Inc.

Brian is a leader in developing innovative solutions for the cities of the future. Brian founded Koloni in 2015 with the idea of creating mobility solutions for small and medium-size communities. Since that time he has developed a suite of hardware and software products, enabling cities of all sizes to deploy their systems. As CEO, Brian has helped Koloni launch micro-mobility fleets in +20 cities and universities across the country. A Chicago based company, Koloni was listed by Forbes.com as 1 of 9 startups to watch in micro-mobility. Brian has also led a new frontier in public sharing solutions by developing a programmable smart locker for public sharing and delivery.

ED DIFIGLIA

Program Manager, New Jersey Future

As program manager, Ed provides day-to-day supervision of the Jersey Water Works collaborative, which is working to upgrade New Jersey's water infrastructure with cost-effective, sustainable solutions. Before joining New Jersey Future's staff, Ed worked at the Stony Brook-Millstone Watershed Association protecting water quality and environmental resources through local engagement with residents, volunteers and other stakeholders. Ed holds a bachelor's degree in journalism from Saint Michael's College in Vermont and a master's degree in legislative affairs from The George Washington University.

REV. ERIC DOBSON

Deputy Director, Fair Share Housing Center

Eric is the Deputy Director of the Fair Share Housing Center, whose mission is to end discriminatory or exclusionary housing patterns which have deprived the poor, particularly those presently living in inner cities, of the opportunity to reside in an environment which offers safe, decent, and sanitary housing near employment and educational opportunities. Eric is an ordained minister, community organizer, and social entrepreneur. He has extensive experience working with diverse

audiences and communities and specializes in interfaith outreach. He co-founded Open Communities LLC (a racial integration consultant firm) that works to resolve simple and complex conflicts of race, ethnicity and socio-economics. He also founded a non-profit focused on youth development and education called Planting Seeds of Hope.

TAVIS DOCKWILLER

Founder and Principal, Viridian Landscape Studio

Tavis is principal and guiding influence for Viridian Landscape Studio. Viridian heals ecological systems while making beautiful places for people. Viridian's designs give people meaningful ways to engage with the environment – to play, learn and relax. Tavis hold a mayoral appointment to Philadelphia's Civic Design Review Committee shifting architect's and developer's projects toward positive impact on the public realm. She was a primary author for "High Performance Landscape Guidelines 21st Century Parks for NYC." Tavis firmly believes that problem solving should be fun; client-consultant teams can make a difference to the world both socially and environmentally; and design solutions should be practical and lyrical.

CAROLINE EHRLICH

*Chief of Staff, Woodbridge Township
Executive Director, Woodbridge Township
Redevelopment Agency*

Caroline Ehrlich has been in her current roles since 2007. During her tenure, the RDA and township administration have designated more than 40 redevelopment areas and have begun an aggressive effort to implement the many redevelopment plans that were subsequently adopted by the township council. As chief of staff, Caroline coordinates with the department directors and oversees the mayor's initiatives. Since 2008, she has served as the sustainability officer for the township, spearheading Greenable Woodbridge and overseeing the Sustainable Jersey certification effort. Through her leadership, Woodbridge has been the Sustainable Jersey champion since 2009. Caroline has also served as chief of staff

to state treasurer John E. McCormac and was a Woodbridge Township councilwoman.

NATASHA ENCARNACION, JD

*Assistant Director of Programs, New Jersey
Housing & Mortgage Finance Agency*

Natasha Encarnacion has worked at the New Jersey Housing and Mortgage Finance Agency for approximately 15 years in various positions. Starting as an intern in the Community Development Department helping to create the NJ Housing Resource Center (NJHRC) website, she currently serves as the Assistant Director of Programs in the Single-Family Division. She holds a bachelor's degree in Urban Studies from Douglass College/Bloustein School at Rutgers University and a Juris Doctorate from Rutgers Camden School of Law. Natasha's career has focused on affordable housing policy issues as well as the creation and management of affordable housing, foreclosure prevention and consumer lending programs. She also served as a founding board member of the Affordable Housing Professionals of New Jersey (AHPNJ).

DANIELLE ESSER

*Director of Governance & Strategic
Initiatives, New Jersey Economic
Development Authority*

Danielle Esser serves as the Director of Governance and Strategic Initiatives at the New Jersey Economic Development Authority. Danielle has worked in various agencies of New Jersey state government for more than 18 years, specifically in the areas of public policy, land use, community and economic development and governance. Danielle is a graduate of Rutgers University with a Masters of Public Affairs and Politics from the Edward J. Bloustein School of Planning and Public Policy and a Bachelor of Arts from Douglass College. Danielle is a licensed professional planner and volunteers her time by serving on the local land use board, and the boards of civic-minded non-profit organizations.

JULIA FAHL

Mayor, City of Lambertville; Vice President of Legislative Affairs, Tonio Burgos and Associates

Julia Fahl is currently serving her first term as Mayor for the City of Lambertville. Outside of the City, Julia is the Vice President of Legislative Affairs at Tonio Burgos and Associates. She has over a decade of experience working as a political professional - supporting progressive causes and candidates across the country. She is an expert in creating and funding both political and issue-based campaigns. Julia was recently profiled in the New York Times "A 28-Year-Old Novice, She Took on the Machine and Won" (2018). She has also been recognized by InsiderNJ as Top 20 most influential Millennials in New Jersey. She is a proud graduate of Bryn Mawr College.

KATHLEEN FOLEY

Compliance Investigator and Field Quality Assurance Coordinator, USEPA Region 2 Monitoring & Assessment Branch

Kathleen is a Compliance Investigator with the USEPA performing sampling and evaluations primarily for the water and wastewater programs, typically on-site or from boats and helicopters. She began her federal career as an Agriculture Inspector with USDA APHIS in Customs at the St. Croix airport where she made her connections with EPA. As a charter member of their office Environmental Management System (EMS) Team, she manages the waste reduction program, continually finding ways to repurpose and reuse items and reduce waste generation. She earned her B.S. degree in Biology and Geology from the University of Rochester, where she completed her field studies at the West Indies Laboratory on St. Croix, USVI.



K&A

IS PROUD TO SUPPORT
NEW JERSEY FUTURE
IN THEIR MISSION TO
SECURE **COMMUNITY**
VITALITY AND
QUALITY OF LIFE

100 Monitor
Hoboken, NJ

Collingswood NJ
856.854.1880
kitchenandassociates.com

 **Kitchen & Associates**
Architecture • Engineering • Planning • Interiors

DAVE FRIED

Mayor, Robbinsville Township

Dave Fried is currently serving his fourth term as mayor of Robbinsville, NJ. Mayor Fried has focused on economic development, shared services, and streamlining government. He remains a leader in the small business community thanks in part to a “Keep it Local” awareness program that encourages keeping revenue and jobs in town. He also is a successful businessman and entrepreneur. As the CEO of Robbinsville-based TriCore Human Capital Management (HCM), Dave and his employees provide integrated payroll, benefits administration and human resources management services to employers. In 2012, TriCore became the second company Dave has vaulted into the prestigious Inc. 5000 as one of the nation’s fastest-growing human resources companies.

WILLIAM GALLMAN, JR.

Council Member, City of Elizabeth

William Gallman was elected to his first term as the Fifth Ward Councilman in the City of Elizabeth in 2003 and he is serving his fifth four-year term. William was nominated by his colleagues for President of City Council four times. He is currently the liaison for the City of Elizabeth Office of Emergency Management. William is the former President of Local 399 for the County of Union, the Weed & Seed Program, and the African American & Haitian Coalition. William is an Ordained Deacon and Chairman of the Deacon Board for St. Paul’s Baptist Church in Elizabeth. William graduated from Gallman High School, South Carolina and attended Allen University, Columbia, South Carolina.

ELENI GIANNIKOPOULOS, PE

*Client Manager/Project Coordinator,
Suburban Consulting Engineers*

Eleni serves as the client service lead for water/wastewater and municipal clients, working closely with utility directors, elected officials, administrators, city managers, and chief financial officers to review capital improvement plans and develop funding programs tailored to each client’s needs. Eleni

works closely with public agencies to ensure successful project milestones are met from inception to completion while securing state funding for low-interest financing through the NJIB and NJTIB. She is involved with large projects which require state and federal permitting, and coordinates task leaders of multiple disciplines to develop a successfully integrated project.

PARRIS GLENDENING

*President, Leadership Institute and
Governor’s Institute on Community Design,
Smart Growth America*

Gov. Parris N. Glendening is President of Smart Growth America’s Leadership Institute and the Governor’s Institute on Community Design. In these roles, he travels across the country and around the world advising state and local governments on smart growth, sustainability, global climate change, land conservation, transit oriented development, and equity. Parris Glendening served as Governor of the State of Maryland from 1995-2003 where he created the nation’s first state-level smart growth policy package, for which he received Harvard University’s Innovations in American Government Award. Prior to being elected Governor, Glendening served three terms as elected county executive of Prince George’s County, Maryland. He taught political science at the University of Maryland, College Park for 27 years and is the author of two books and over 100 articles and conference papers.

AISHA GLOVER

President & CEO, Newark Alliance

Aisha Glover serves as the President & CEO of the Newark Alliance, which plays a key role in leveraging the city’s corporate and anchor communities’ collective impact and helps carry out Mayor Ras J. Baraka’s vision for inclusive economic growth. She has over 15 years of experience as a convener, champion and agent for economic empowerment and social justice. Aisha is a New Jersey Future trustee. She holds a Bachelor of Arts Degree from Hunter College of the City University of New York, a Masters of Public Administration from

Baruch College of the City University of New York and an executive leadership certificate from the Columbia Business School, School of Social Enterprise.

THOMAS GOLETZ

Vice President, Newark Downtown District

Thomas joined the Newark Downtown District in March of 2015. In this role, he manages a \$2.1 million budget, and supervises the Ambassador team and the Horticulture team. Thomas routinely coordinates safety programs with the Newark Police Department and works with various City representatives to improve the quality of life in the downtown district. He previously served as Captain and Commanding Officer of the Intelligence Section at the New Jersey State Police, where he supervised 178 detectives in the areas of narcotics, gangs, weapons trafficking, counter terrorism, and public corruption.

EMILY GREENFIELD, PHD

Associate Professor, School of Social Work, Rutgers University

Emily Greenfield is an Associate Professor (Ph.D., Human Development and Family Studies, University of Wisconsin-Madison, 2007). Her research aims to support efforts to improve social environments for diverse populations of older adults and families. Her areas of scholarly expertise include age-friendly community initiatives, aging-in-place supportive service programs, civic engagement in later life, and the long-term health effects of social inequalities in childhood. She uses a range of methodologies in her work, including secondary analysis of quantitative data, in-depth qualitative interviewing, collecting new survey data, and community-based participatory research approaches. Greenfield's research has received support from the National Institute on Aging, The John A. Hartford Foundation, The Henry and Marilyn Taub Foundation, the Silberman Fund for Social Work Faculty Research, and the Grotta Fund for Senior Care.

RAMON HACHE

Mayor, Village of Ridgewood

Ramon M. Hache, Sr. was elected to the Ridgewood Village Council in 2016 and became Mayor in 2018. Ramon serves on the Planning Board, Parks & Recreation, Fields Committee, and the Central Business District Advisory Committee. He is Village liaison to the Board of Education and also currently serves on the Board of the Bergen County Open Space Trust Fund. Ramon had an extensive professional career in asset and wealth management having worked at some of the leading global private wealth and asset management companies. Ramon attended Marist College and graduated with a B.S. in Business Administration.

BRUCE HARRIS

Commissioner, New Jersey State Planning Commission

Bruce Harris served as mayor of Chatham Borough, a Silver certified Sustainable Jersey community, from January 2012 through December 2019, as a member of the Borough Council from 2004 until 2011, and also served on the Planning Board, Environmental Commission and Open Space Committee. In 2017, Bruce received the Mayor Art Ondish Leadership award from Sustainable Jersey. His nomination by Governor Murphy to serve on the New Jersey State Planning Commission was confirmed by the State Senate in January 2020. He is a retired attorney who practiced privately for 20 years and served as General Counsel to the New Jersey Turnpike Authority for 5 1/2 years. Prior to becoming an attorney, Bruce held various managerial positions within the former Bell System companies.

W. DAVID HENDERSON, AIA, LEED AP-BD+C

Principal, HHG Development Associates, LLC

Building sustainable and vibrant communities is the passion that drives David's real estate development career and informs the design of his projects. Roebling Center, a 475,000 SF mixed-use development in Trenton, comprises residential lofts, Class A office space and restaurant/hospitality, all arrayed around a

Leading the way to a clean energy future



www.njrsustainability.com



**New Jersey
Natural Gas**

central courtyard programmed with arts and festival events. David is a Registered Architect in NJ, NY and PA, and a LEED AP with a specialty in building design and construction. David is President of the Trenton Film Society, Treasurer of Newtown Friends School, board member of Trenton Downtown Association and member of St. Michael's Episcopal Church vestry. David received a Master of Architecture from the University of Virginia and a Bachelor of Arts from the University of Pennsylvania.

CHARLES HEYDT, PP, AICP, LEED AP ND

*Associate Director, Planning Services,
Dresdner Robin*

As Associate Director of Planning Services, much of Charles Heydt's work at Dresdner Robin is focused on the key components of land use and environmental planning. He places a strong emphasis on development feasibility, redevelopment, environmental and fiscal impact analysis, and sustainability. Charles earned his Bachelor of Science degree in Economics from The College of

New Jersey and a Master of City and Regional Planning (MCRP) degree from the Bloustein School of Planning and Public Policy at Rutgers University. A long-time member of the American Planning Association (APA) and the U.S. Green Building Council (USGBC), he continues to serve on the APA-NJ Executive Committee.

ADRIENNE HOLLIS, PHD, JD

*Senior Climate Justice & Health Scientist,
Union of Concerned Scientists*

Adrienne leads the development, design, and implementation of methods for accessing and documenting the health impacts of climate change on communities of color and other traditionally disenfranchised groups. Adrienne works with environmental justice communities to identify priority health concerns related to climate change and other environmental assaults and evaluates climate and energy policy approaches for their ability to effectively address climate change and

benefit underserved communities. She is developing and scoping a new research agenda and strategy on climate and health; evaluating climate and energy policies to reduce exposure to negative health and environmental impacts; and recommending policy approaches to foster inclusiveness and greater benefits to underserved communities, and effectively address climate change. Adrienne is an environmental attorney and an environmental toxicologist, with a PhD from Meharry Medical College and a JD from Rutgers School of Law – Newark.

STEPHANIE HUNSINGER

State Director, AARP New Jersey

Stephanie, overseeing the State office staff and volunteers, sets the strategic planning and direction for AARP at the state and local level serving the 1.3 million AARP members and the 50+ in the state. In 2016, Stephanie was appointed to the NJ Task Force on Abuse to the Elderly and Disabled, currently serving as a member of the Advisory Committee for the NJ Action Coalition. Stephanie previously served

as Manager of Patient Services and Advocacy for ProCure Proton Therapy Center, leading a team focused on the development and implementation of patient care programs.

KARIM HUTSON

Founder & Managing Member, Genesis

Karim founded Genesis in 2004 and under his stewardship Genesis Companies has grown rapidly and developed a reputation for building high quality projects that enhance urban centers while remaining accessible to the residents of these communities. Karim is the Treasurer of the Trustee Board of First Corinthian Baptist Church, Trustee of the Citizens Budget Commission, Trustee of the Randall’s Island Park Alliance Board, Board Member of Citizens Housing Planning Council, Member of the Leadership Council for Habitat for Humanity NYC and a Member of the Executive Committee of the New York State Association for Affordable Housing. Karim holds a B.A. in Economics and Philosophy from Amherst College, an M.B.A. from Harvard Business School and a M.T.S. from Harvard Divinity School.

RWJBarnabas Health
proudly supports
New Jersey Future’s Annual
Redevelopment Forum.



rwjbh.org

EMILY JABBOUR

Council Member, City of Hoboken

Emily (Ball) Jabbour was elected on November 7, 2017 as a Councilperson-at-Large for the City of Hoboken, New Jersey. Currently Emily serves as Co-Chair of the Budget, Finance and Infrastructure Subcommittee, as well as member of the following subcommittees: Health and Human Services, Environmental Services, and Parking and Transportation. Emily graduated from Boston College in 2003 with a B.A. in Psychology and Columbia's School of Social Work in 2006 with a Master of Science in Social Work. Upon graduating from Columbia, Emily was accepted to the highly competitive Presidential Management Fellows program and began working for the Administration for Children and Families (ACF), part of the U.S. Department of Health & Human Services in Washington, DC.

DAN KENNEDY, PP/AICP, MCRP

Director of Environmental & Utility Operations, Utility and Transportation Contractors Association (UTCA) of NJ

Dan serves as the Director of Environmental & Utility Operations at UTCA NJ, a trade association with members that delivers a wide range of infrastructure solutions for the public and private sectors. He serves on the Steering Committee of Jersey Water Works and is Chairman of the national Clean Water Construction Coalition. Prior to his role with UTCA, he served as an Assistant Commissioner at the New Jersey Department of Environmental Protection, Deputy Director of the New Jersey Office for Planning Advocacy. He is a licensed professional planner with a MCRP from Rutgers' Edward J. Bloustein School of Planning & Public Policy and a B.S. in Environmental Science from the University of Delaware. Dan serves as Chair of Bordentown City's Planning/Zoning Board and the Vice Chair of the Burlington County Agricultural Development Board.

ALLEN KRATZ

Principal, Resilience Works, LLC

Allen Kratz brings four decades of experience in funding and project management to the challenge of paying for communities' climate

resilience infrastructure from New Jersey to Maine. At New York University's Institute for Public Knowledge, Allen tracked the progress of seven HUD-funded post-Superstorm Sandy Rebuild by Design Projects. In his hometown of Hoboken, Allen serves on the Citizens Advisory Committee for the \$230 million RBD project and oversaw floodproofing of the Hoboken Public Library with \$2.2 million of federal, state, county, city funding. In Brooksville, Maine, Allen serves on the town's Comprehensive Plan Committee, underscoring the importance of funding coastal resilience projects with a comprehensive, synergistic package of state, federal and private-sector grants and loans.

ISAAC KREMER

Executive Director, Metuchen Downtown Alliance

Isaac Kremer is a nationally recognized expert in the Main Street Approach® to commercial district revitalization. He has nearly two decades of experience working with Main Street and historic preservation organizations in Michigan, New York, Texas, Kentucky, and now New Jersey. Kremer secured over \$2 million in grants and has leveraged over \$150 million of investment. His education and training includes a M.A. in Historic Preservation Planning from Cornell University, and a B.A. in Economics and Management from Albion College in Albion, Michigan. Kremer has had additional training in historic preservation tax credits, historic real estate finance, economic development, community philanthropy, and the 'How to Turn a Place Around' training from the Project for Public Spaces.

ANDY KRICUN

*Senior Advisor, Moonshot Missions;
Senior Fellow, US Water Alliance*

Andy Kricun is serving as a Senior Fellow with the US Water Alliance. He has 35 years of experience in wastewater and biosolids management, serving as the Executive Director and Chief Engineer of the Camden County (NJ) Municipal Utilities Authority until his recent departure earlier this year. He will be working with Radhika Fox and her staff on the USWA's water equity initiative

and also providing technical expertise. He has served on the board of the National Association of Clean Water Agencies and on the New Jersey Environmental Justice Advisory Council. Andy graduated with honors from Princeton University with a degree in Chemical Engineering. He also holds a professional engineer's license in Civil Engineering and is a board certified environmental engineer.

LANCE LANDGRAF, JR.

Commissioner of Public Works and Construction, Ventnor City

Lance was elected to municipal office as a Ventnor City Commissioner in May of 2016. As the Commissioner of Public Works, Construction and Code Enforcement, Lance is in charge of public works that includes the Streets, Buildings/Facilities, Sewer and Water Departments and maintenance of parks and playgrounds. From municipal planning for the City of Brigantine and Mullica Township to preparing site plans, subdivisions and variance applications, Lance has reviewed and designed projects with the benefit of experience from both the developers' point of view and the municipal agency aspect of development. Lance graduated from Bloomsburg University of Pennsylvania with a Bachelors degree in Urban/Regional Planning and has over 30 years of experience in land development and land use planning.

WALTER LANE

Director of Planning, Somerset County

Walter Lane serves as the Director of Planning for Somerset County. He is responsible for all of the County's planning efforts, the Office of Solid Waste Management, Agriculture Development Board, the County's Cultural and Heritage Commission and the Somerset County Energy Council. Walter is a licensed New Jersey Professional Planner and is a member of the American Institute of Certified Planners. He currently serves as the President of the NJ County Planners Association and on the Executive Committee of the Somerset County Business Partnership. Walter also serves as the co-chair of the Sustainable Jersey Transportation and Land Use Taskforce and the

Obesity Task Force of Healthier Somerset. He is a graduate of Cook College, Rutgers University and holds a B.S. in Environmental Policy.

ERIN LAW, ESQ.

Partner, McManimon, Scotland & Baumann, LLC

Erin Law is a partner at McManimon, Scotland & Baumann, LLC with a practice that focuses primarily on public finance, redevelopment, and economic development. She currently represents school boards, municipalities, local authorities, and redevelopment agencies as bond counsel and redevelopment counsel and several libraries as general counsel. Erin has experience in transactions involving public bodies resulting in the financing of a variety of projects throughout New Jersey. She has extensive experience representing borrowers and conduit borrowers participating in the New Jersey Infrastructure Bank Financing Program and other pooled loan programs. Erin was selected to serve on the City of Hoboken's Rebuild By Design Citizen Advisory Group and is a member of the Board of Trustees of The Waterfront Project.

BILL LINDNER

Administrator, Office of Brownfield & Community Revitalization, New Jersey Department of Environmental Protection

Bill Lindner is the Administrator of the Office of Brownfield and Community Revitalization at NJDEP, which is charged with coordinating remediation and reuse efforts at specific brownfield sites and piloting innovative approaches to expedite the revitalization process. Bill also leads the Community Collaborative Initiative (CCI) Program. The CCI works closely with diverse partners in urban communities to support their vision for revitalization and growth. Prior to managing OBR, Bill spent over two years developing and managing programs integral to New Jersey's recovery from Superstorm Sandy. He also has extensive work experience as a contaminant hydrogeologist and project manager. He has a Bachelor's Degree in Geology from Rutgers University and a Master's Degree in Environmental Policy from the New Jersey Institute of Technology.

MARK LOHBAUER

Principal, JGSC Group, LLC

Mark is an economic development policy advisor who became a principal at JGSC Group in 2004. He is a lawyer who, prior to joining the firm, served respective turns as a township and county elected official and as an Assistant State Treasurer in Governor Christie Whitman's administration. He has managed commercial revitalization projects throughout New Jersey, in all five boroughs of New York City, and in communities in many other parts of the country. He is a Commissioner on the NJ Pinelands Commission, a member of the Board of Trustees of the NJ Highlands Coalition, and an adjunct professor of environmental advocacy at Rowan University's Glassboro campus. He is a graduate of Rider University and Rutgers University School of Law-Camden.

GABRIEL MAHON, PE

Chief, Bureau of Nonpoint Source Pollution, New Jersey Department of Environmental Protection

Gabriel Mahon graduated from Lafayette College with a B.S. in Chemical Engineering and is currently a licensed professional engineer in both Pennsylvania and Delaware. He spent 12 years in NJDEP's Division of Land Use Regulation reviewing engineering aspects of Land Use Regulation applications to ensure compliance with the Flood Hazard Area Control Act Rules, Coastal Zone Management Rules, Stormwater Management Rules, and Freshwater Wetlands Protection Act Rules. He is responsible for managing the NJPDES industrial stormwater permitting program, the NJPDES discharge to groundwater program, the onsite wastewater management (septic system) program, and the municipal stormwater regulation program, which includes the Stormwater Management Rules and the NJPDES municipal separate storm sewer system (MS4) permitting program.

GIRIDHAR MALLYA

Senior Policy Officer, Robert Wood Johnson Foundation

Giridhar Mallya is a public health physician and health policy expert at RWJF focusing on state and local policy for achieving a Culture

of Health. Giridhar was director of Policy and Planning for the Philadelphia Department of Public Health, where he led the Department's Get Healthy Philly tobacco control and obesity prevention initiatives to reduce adult and youth smoking and childhood obesity while narrowing racial and socioeconomic disparities. Giridhar earned a bachelor's degree in biology from Brown University, graduated from the Warren Alpert Medical School at Brown, and completed a residency in Family and Community Medicine at Thomas Jefferson University Hospital in Philadelphia. He received a master's in health policy from the University of Pennsylvania, where he was a Robert Wood Johnson Foundation Clinical Scholar.

CATHERINE MCCABE

Commissioner, New Jersey Department of Environmental Protection

A recognized leader in environmental protection, Commissioner Catherine R. McCabe guides the NJDEP in protecting New Jersey's environment and public health. Commissioner McCabe leads the NJDEP's efforts to achieve Governor Phil Murphy's environmental goals, including reaching 100 percent clean energy by 2050 and preparing New Jersey residents to adapt to climate change. Under Commissioner McCabe, the NJDEP's top priorities are reducing and responding to climate change, protecting New Jersey's water, revitalizing communities and protecting public health, managing and promoting New Jersey's thriving natural resources, and strengthening the NJDEP.

EDWARD MCKENNA, ESQ.

Senior Partner, McKenna, DuPont, Higgins & Stone

Edward McKenna represents more than 50 credit unions, banks, planning and zoning boards, businesses, major developers, and hundreds of private clients in his law practice. He has more than 20 years of public service as councilman and then mayor of the Borough of Red Bank. Under his leadership, the borough was cited numerous times as one of the best examples of a renaissance city by national publications including The New York

Times, New York Post, Washington Post, and Smithsonian Magazine. Edward is the co-founder and past chairman of the Two River Council of Mayors. He serves on the New Jersey State Planning Commission and was its Chair until 2020.

**JOSEPH MELE PE, PLS, PP,
LEED-AP, CPESC**

Director of Civil Engineering, Dresdner Robin

Joe oversees a wide array of land development projects throughout New Jersey, New York and Pennsylvania. His 25 plus years of experience in the industry covers a wide range of knowledge and skills including: site design, land development planning, stormwater management, roadway design, water and sanitary sewer design, utility layout, erosion controls, septic design, cost estimating, boundary and topographic surveying, subdivisions, and construction layouts. Joe is a licensed professional engineer in New York, New Jersey and Pennsylvania; a licensed professional land surveyor and professional planner in New Jersey; a LEED accredited professional; and

certified professional in erosion and sediment control. He earned bachelor's degrees in both Engineering and Land Surveying from the New Jersey Institute of Technology and Fairleigh Dickinson University.

STEVEN MLENAK, ESQ.

Partner, Greenbaum, Rowe, Smith & Davis LLP

Steven Mlenak is a partner in the Redevelopment & Land Use and Real Estate Departments at Greenbaum, Rowe, Smith & Davis LLP in New Jersey. His practice is focused in the areas of redevelopment, land use, zoning, and real estate development. His clients include property owners and developers engaged in mixed-use, residential, industrial, commercial, office, retail, and affordable housing development projects. Steven provides guidance from the initial project concept through to construction, including land use planning and approvals, permits and variances and appearances before municipal, county and state planning and zoning boards and agencies. Steven also maintains a strong practice in the area of community association law, providing

WE KEEP MAKING HEALTH CARE BETTER.

At Hackensack Meridian *Health*, excellence is the standard, where researchers fast-track breakthroughs into life-changing care. We're also sharing our clinical expertise through HealthU, providing much needed wellness information to the community, so you can live your healthiest life. We offer a full spectrum of services – from virtual appointments to treating the most complex conditions. Here, everyone works together to make you better.

HackensackMeridianHealth.org
844-HMH-WELL



**Hackensack
Meridian *Health***
KEEP GETTING BETTER

strategic guidance and general counseling to condominium and homeowners association clients across a broad range of legal issues.

BRAD MOLOTSKY, ESQ.

Partner, Duane Morris LLP

Brad practices in the area of real estate law. He serves as a team lead for the Duane Morris Project Development/P3 industry group and as co-head of the firm's Opportunity Zones practice group. Brad's primary practice is focused in the areas of opportunity zone fund creation and fund deployment, financing, public private partnership, real estate joint ventures, commercial leasing, and acquisitions and divestitures. Brad is a cum laude graduate of Villanova University Law School, where he was Order of the Coif, and also earned an M.B.A. in Finance from Villanova University. He is a cum laude graduate of the University of Delaware. Brad has also earned his LEED AP O+M certification. He also has earned an AV Preeminent® peer review rating from Martindale-Hubbell®.

SEAN MORIARTY, ESQ.

Chief Advisor for Regulatory Affairs, New Jersey Department of Environmental Protection

Sean leads and manages NJDEP's internal legal team and serves as its general counsel on all matters of regulatory compliance and rule-making. He is also a member of the Commissioner's executive team, providing input on priority initiatives that include climate change and environmental justice. Previously, Sean served as a Regulatory Officer with the Bureau of Legal Services and Stewardship for NJDEP's Green Acres Program. He had joined that team in May 2017, after several years representing the program as its Deputy Attorney General. Sean received both his undergraduate and law degrees from Rutgers University.

LAUREN OTIS

Executive Director, ArtWorks Trenton

Lauren Otis is Executive Director of Artworks, Trenton's visual art center. At Artworks, he has overseen multiple public art projects, including

the 2019 restoration of internationally famous artist Nam June Paik's monumental neon and video installation in Trenton, PBS (1963-2000). Along with multiple stakeholders, he is currently engaged in planning for Trenton's Artwalk project, which will use public murals, sculpture and lighting installations to beautify and improve the pedestrian route along a highway underpass linking the Trenton Transit Center and downtown Trenton. Lauren's own art and photography has been exhibited widely in the region, and his writing has appeared in *The New York Times*, *The Trenton Times*, *Poets & Writers*, PlanetTrenton.org, and elsewhere.

JACK PARUTA, AIA, LEED AP BD+C

Senior Project Architect, Gensler

Jack Paruta has more than 25 years of experience as a project architect. He specializes in hospitality work that cuts across a wide range of project types including adaptive reuse, new construction, major renovations and additions. Jack has developed a prominent portfolio of work focusing on the adaptive reuse of historic buildings, many involving federal historic tax credit applications. Recent projects include the conversion of the New York Life Building in Chicago into the award winning The Gray Hotel in Chicago and the historic Lafayette Building into the Hotel Monaco in Philadelphia. He's spoken at length on adaptive re-use, historic tax credits, and LEED/sustainable design and how each is shaping the hospitality industry and revitalizing neighborhoods.

BARKHA PATEL

Director of Transportation Planning, City of Jersey City

Barkha Patel is the Director of Transportation Planning for the City of Jersey City. In this role, she manages all transportation planning activities for the City, serves as Co-Chair of the Jersey City Vision Zero Task Force and represents the City at the North Jersey Transportation Planning Authority. Barkha's work focuses on active transportation, urban design, and placemaking. She oversees the City's long range transportation initiatives,

including development of the City's first-ever Vision Zero Action Plan, School Travel Plan, and Bicycle Master Plan, and advancement of infrastructure improvements with a commitment to smart growth and equity. Barkha earned a Bachelor's degree in Sociology from Rutgers University's School of Arts and Sciences and a Master's of City and Regional Planning from the Bloustein School.

KANDYCE PERRY

*Planning and Policy Manager,
New Jersey Future*

Kandyce manages New Jersey Future's Mainstreaming Green Infrastructure program, which assists communities, developers, and design professionals in using green stormwater infrastructure. Kandyce also coordinates the Green Infrastructure Committee of the Jersey Water Works collaborative, which is working to upgrade New Jersey's water infrastructure with cost-effective, sustainable solutions, and she coordinates the City of Trenton's Municipal Action Team for community engagement and outreach on green infrastructure. Kandyce holds a master's degree in Environmental Studies with a concentration in Environmental Policy from the University of Pennsylvania and a B.S. in Environmental Science from Spelman College. Kandyce is a graduate of the Environmental Leadership Program and currently participates in the DiverseForce on Boards program at the University of Pennsylvania.

MARJORIE PERRY

*President & CEO, MZM Construction
and Management*

Marjorie Perry built a career working for large corporations such as 3M and United Airlines before launching a consulting firm that helped entrepreneurs succeed in the marketplace. MZM Construction, one of her clients at the time, asked her to join the business as a partner. She eventually became the sole principal and CEO, and the firm enjoyed over 27 years of profitable performance under her leadership. Marjorie received her MBA from NJIT and has been listed in NJBIZ as one of New Jersey's Best 50 Women in Business and

as one of the state's Top 25 Entrepreneurs. Marjorie was a board member of the New Jersey Economic Development Authority and in 2012 was named NJ's Small Business Person of the Year.

DONNA RENDEIRO

Executive Director, Office of Planning Advocacy

Donna Rendeiro was named Executive Director of the Office of Planning Advocacy in the New Jersey Department of State and Secretary of the New Jersey State Planning Commission in 2019. She also serves as the Director of the State Planning Commission. Previously, she served as Chief of Administration for the New Jersey Housing and Mortgage Finance Agency. Donna was the Director of Community Planning at the New Jersey Redevelopment Authority, Acting Executive Director of the Office of Smart Growth, and Brownfields Policy Director. She has worked with the Governor's Office of Economic Growth on urban policy. She has a Bachelor of Science in marketing from Pace University.

PETER ROSE

*Managing Director, Community Enterprises,
Isles Inc.*

As Isles' Managing Director since 2006, Peter Rose oversees a range of family self-sufficiency and health services, including Isles' Center for Energy and Environmental Training, Isles Financial Solutions, housing and homeownership counseling, and residential lead hazard control. Under Peter's leadership, Isles created or expanded services to improve financial capability for low wage workers, lead-safe rehabilitation, and environmental training. His creativity and leadership skills were honed in Seattle, where he founded Ventures, an award-winning nonprofit that provided business training and lending for low income women and people with disabilities. Previously, Peter was the Managing Director of RESULTS, an organizing agency for the Microcredit Summit, which sought to bring microcredit to 100 million of the world's poorest families by 2005. Peter earned a B.A. from Evergreen State College.



Thank you **NEW JERSEY FUTURE** for advancing innovative redevelopment solutions to make all of New Jersey more resilient and prosperous.



© 2020 Valley National Bank. Member FDIC. Equal Opportunity Lender. All Rights Reserved.

ANDREW SALKIN

Founding Principal, Resilient Cities Catalyst

Andrew Salkin is a Founding Principal of Resilient Cities Catalyst, leading RCC's work connecting cities and the private sector to spur innovation and financing to ensure resilient initiatives actually happen. Andrew has over 25 years of experience working in and with cities. He is an urban innovator who specializes in leveraging available budgets, public administration, and governance to drive transformation. Andrew holds a Master's degree in Public Administration from the Maxwell School of Citizenship and Public Affairs at Syracuse University and a B.A. in Economics from the University of Wisconsin—Madison.

EMILY SCHWENINGER

Deputy Director, Thriving Communities, Smart Growth America

Emily Schweninger is the Deputy Director of Thriving Communities, a program of Smart Growth America. A public health professional with over 13 years of experience,

Emily leverages her diverse programming and research expertise to support the National Complete Streets Coalition, Rural Communities Development, and other projects within the Thriving Communities team, to build stronger, more resilient communities by promoting health and equity through the built environment. Emily began her career in New Orleans, working in disaster response and recovery after Hurricane Katrina, and also has extensive experience working in global health. She holds a Bachelor of Arts from the University of North Carolina at Chapel Hill and a Master of Public Health from Tulane University's School of Public Health and Tropical Medicine.

PANDORA SCOOTER

Pandora Scooter is a nationally recognized spoken word artist who has toured the US twice with her solo shows. Currently, she teaches acting at NYU and other theatre-related courses at Terry Knickerbocker Studio and her own boutique acting company, Working Actors Studio. She has performed

New Jersey's
best days start
today.



Contact Yolanda Swiney
yolanda.swiney@pnc.com

©2020 The PNC Financial Services Group, Inc. All rights reserved.
PNC Bank, National Association. **Member FDIC**
CON PDF 0618-0106



in New York City, Philadelphia, New Haven, Newark, Jersey City, Washington DC, Dallas, Jackson, Nashville, Houston, Austin, Topeka, among many other cities. Her newest play, *Masks*, is under option for production. She is a graduate of Mason Gross School of the Arts and has lived in Highland Park for 28 years.

LIZ SEMPLE

*Senior Planning Advisor, New Jersey
Department of Environmental Protection*

Liz Semple, Senior Planning Advisor, represents NJDEP and Commissioner McCabe on the newly reestablished State Plan Commission. Liz is working with multiple partners to create guidance for communities on how to adapt to flood risks from climate change. Liz is working with Rutgers University and the Coastal Resilience Collaborative to produce the first Coastal Ecological Restoration and Adaptation plan that will identify priority ecological projects by region with the goals of sequestering carbon, enhancing ecological services, and/or improving community

resilience. Liz previously lead multiple Department water, land use and planning and policy programs and efforts.

NICK SIFUENTES

*Executive Director, Tri-State Transportation
Campaign*

Nick Sifuentes is the Executive Director of Tri-State Transportation Campaign, where he has led winning campaigns for New Jersey Transit board reform, increased funding for New Jersey Transit and the MTA, congestion pricing, and bus lane enforcement. Nick comes to TSTC from the Riders Alliance, where he served as Deputy Director. There, he led campaigns to call on the State Legislature to fix and fund New York City's public transit, create a half-priced MetroCard program for low-income residents known as Fair Fares, and revamp ailing bus service in New York City. He is a graduate of the University of California, Los Angeles.

ERIKA STAHL, PP / AICP

*Managing Partner, Swick, Stahl & McGurk
Planning Associates, LLC*

Erika Stahl is a New Jersey Licensed Professional Planner (P.P.) and a licensed American Institute of Certified Planner (AICP). She is a managing partner of Swick, Stahl & McGurk Planning Associates, a land use planning consultant firm. Erika has approximately 12 years of diverse planning experience ranging from affordable housing, military compatibility planning, transportation planning, post-disaster planning, sustainable and resiliency planning, economic development planning, and long-range planning. She has prior experience working at the state, county, and municipal level. Erika earned a master's degree in City and Regional Planning in 2012 from the Edward J. Bloustein School of Planning and Public Policy.

MICHAEL STATON

*Vice President, Mortgage Officer, CPC Mortgage
Company LLC*

Michael Staton is a Vice President and Mortgage Officer at CPC Mortgage Company LLC, a subsidiary of The Community Preservation Corporation (CPC) that focuses on the company's Freddie Mac, Fannie Mae, and FHA lending. His experience includes financing multifamily housing developments, office buildings, retail centers and industrial space, managing relationships with clients and investing in Low Income Housing Tax Credit properties, as a Limited Partner, to create and preserve multifamily, affordable housing and to maximize the rate of return to Investors for property acquisitions. Staton holds a Bachelor's Degree in Finance from Hampton University and a Master's Degree from Rider University.

CHRIS STURM

*Managing Director, Policy and Water,
New Jersey Future*

Chris directs New Jersey Future's water programs and policy. Her work focuses on efforts to upgrade water infrastructure to support healthy, just and prosperous communities, and includes facilitating the Jersey Water Works collaborative and managing the organization's work on green infrastructure, water financing, and community organizing. She has built successful teams and collaborations to accomplish legislative, regulatory and programmatic innovations in areas including climate resilience, state and regional planning, land preservation, and compact, equitable growth. She is a member of the U.S. Water Alliance. She holds a master's degree in Public Affairs from the Woodrow Wilson School at Princeton University, where she concentrated in Urban and Regional Planning.

TIM SULLIVAN

*Chief Executive Officer, New Jersey
Economic Development Authority*

Since joining the New Jersey Economic Development Authority as Chief Executive Officer, Tim has led the NJEDA's transformation into a comprehensive economic development organization, including the creation of new offices and initiatives aimed at implementing Governor Phil Murphy's vision for a stronger and fairer economy by enhancing New Jersey's long-term economic competitiveness in strategic sectors and communities across the state. Tim has overseen the creation of the NJEDA's Office of Economic Transformation, the Office of International Trade & Investment, the Office of Policy, Planning and Research, and a dedicated Small Business Unit. Tim most recently served as Deputy Commissioner of the Connecticut Department of Economic and Community Development, where he oversaw State tourism and branding, brownfield redevelopment, transit-oriented development, and waterfront initiatives. Tim is a graduate of Georgetown University.

PATRICK TERBORG

Founder & Managing Partner, TD+ Partners

Patrick is the founder of and managing member at TD+Partners, a New Jersey based real estate development firm. He has more than 10 years of experience in real estate development and more than 15 years of financial management experience in real estate development, major financial corporations and higher education. Patrick has been instrumental in obtaining equity and debt financing that has led to the development of more than 500,000 square feet of mixed used space in the urban core of Essex County and Union County. As a developer, he has successfully sought and obtained approvals in urban areas within the last three years for over 1 million square feet of mixed-use development with significant zoning enhancements.

RONDA URKOWITZ, PP, AICP

Executive Director, Cross County Connection TMA

Ronda Urkowitz is the Executive Director of Cross County Connection TMA. Cross County Connection is South Jersey's designated Transportation Management Association, providing sustainable transportation planning services to local and county governments, employers and the general public. Ronda has formed public/private partnerships to fund community shuttles and leads collaborative efforts to sustain them, including local and county governments, social services organizations, state agencies, and private sector businesses. Cross County Connection currently provides technical and marketing assistance to shuttle services in Burlington, Atlantic, and Gloucester counties. Ronda holds a Master's Degree in Urban and Regional Planning from George Washington University and is a member of the American Institute of Certified Planners and a New Jersey-licensed Professional Planner.

NIEK VERAART

Senior Vice President & National Lead - Planning, Michael Baker International

Niek serves as Senior Vice President and National Practice Lead - Planning at Michael Baker International with a focus on resilience and smart infrastructure. He led environmental and infrastructure planning services for the post-9/11 redevelopment of Lower Manhattan and post-Superstorm Sandy resiliency planning, including several Rebuild by Design projects and the NY Rising Community Reconstruction Program. He co-authored the "Installation Adaptation & Resilience Climate Change Planning Handbook" for the Naval Facilities Engineering Command and the handbook "Improving the Resilience of Transit Systems Threatened by Natural Disasters." He has published and presented at the annual meetings and in the proceedings of the Transportation Research Board, the Infrastructure Security Partnership and the American Planning Association.



Mortgage Company LLC
A Subsidiary of The Community Preservation Corporation

CPC IS PROUD TO SUPPORT

NEW JERSEY FUTURE'S

2020 Redevelopment Forum

One-stop-shop for all of your multifamily finance needs

Conventional Financing | Multifamily Affordable Housing | Small Buildings | Construction & Permanent

Multifamily Agency Lending

Lets Connect:

website: community.com/mortgagecompany | phone: 855.363.4646



JOIN THE MOVEMENT



Participate in the work of Jersey Water Works and join any of the collaborative's committees;

Receive a bi-weekly email with updates, funding opportunities, news and resources.

Ready to join? Visit our website!

Jersey Water Works is working to transform New Jersey's inadequate water infrastructure through sustainable, cost-effective solutions that provide communities with clean water and waterways; healthier, safer neighborhoods; local jobs; flood and climate resilience; and economic growth.

WWW.JERSEYWATERWORKS.ORG



[@jerseywaterwrks](https://twitter.com/jerseywaterwrks)



[@jerseywaterworks](https://www.facebook.com/jerseywaterworks)

THANK YOU TO OUR PROMOTIONAL PARTNERS!

AARP NEW JERSEY

ALAN M. VOORHEES TRANSPORTATION CENTER

AMERICAN INSTITUTE OF ARCHITECTS, NEW JERSEY CHAPTER

AMERICAN PLANNING ASSOCIATION - NEW JERSEY CHAPTER

THE ASSOCIATION OF NEW JERSEY ENVIRONMENTAL COMMISSIONS

CENTER FOR NON-PROFITS

CREATIVE NEW JERSEY

DOWNTOWN NEW JERSEY

HOUSING & COMMUNITY DEVELOPMENT NETWORK OF NEW JERSEY

NEW JERSEY BUILDERS ASSOCIATION

NEW JERSEY LEAGUE OF CONSERVATION VOTERS

NEW JERSEY POLICY PERSPECTIVE

PRESERVATION NEW JERSEY

REGIONAL PLAN ASSOCIATION

SUSTAINABLE JERSEY

TRI-STATE TRANSPORTATION CAMPAIGN

WATERFRONT ALLIANCE



New Jersey Future is a nonpartisan nonprofit organization that promotes policies and practices for sustainable growth and development in New Jersey.

NEW JERSEY FUTURE SUPPORTS:



Investing wisely in infrastructure



Incorporating climate risk into decision-making



Supporting good local redevelopment



Coordinating state development efforts

LEARN MORE

njfuture.org

[@newjerseyfuture](https://www.instagram.com/newjerseyfuture)



DRESDNER — ROBIN

IDEAS THAT TRANSFORM

PLANNING
ENGINEERING
ENVIRONMENTAL
LANDSCAPE ARCHITECTURE
SURVEY & 3D MEASUREMENT

*40 Years of Leadership in
Planning and Redevelopment*



DRESDNERROBIN.COM

JERSEY CITY - FAIRFIELD - CHERRY HILL - ASBURY PARK
NEW YORK - PHILADELPHIA

THANK YOU TO

TITLE

Bank of America



PROMOTIONAL BAG

MARAZITI FALCON LLP

LUNCHEON AND KEYNOTE

NEW JERSEY NATURAL GAS

RWJBARNABAS HEALTH

BREAKFAST AND PLENARY

HACKENSACK MERIDIAN HEALTH

PENNONI

PNC BANK

**THE COMMUNITY PRESERVATION
CORPORATION**

TRACK

**NEW JERSEY ECONOMIC
DEVELOPMENT AUTHORITY**

**RIKER DANZIG SCHERER
HYLAND & PERRETTI LLP**

SCARINCI HOLLENBECK, LLC

WILENTZ, GOLDMAN & SPITZER, P.A.

TECHNOLOGY

**ATLANTIC CITY ELECTRIC,
AN EXELON COMPANY**

HLW

HUGO NEU CORPORATION

NEW BRUNSWICK CITY CENTER

ROBERT WOOD JOHNSON FOUNDATION

RECEPTION

**FIRST ENERGY FOUNDATION/JERSEY
CENTRAL POWER AND LIGHT**

**GREENBAUM, ROWE,
SMITH & DAVIS LLP**

**NEW JERSEY HOUSING &
MORTGAGE FINANCE AGENCY**

NEXUS PROPERTIES

MUNICIPAL SCHOLARSHIP

PENNROSE

OUR SPONSORS

PHOTOGRAPHY

CLARKE CATON HINTZ
CONIFER REALTY, LLC
KITCHEN & ASSOCIATES
LANGAN
MCMANIMON, SCOTLAND &
BAUMANN, LLC
RPM DEVELOPMENT GROUP

EXHIBITOR

AMERICAN INSTITUTE OF ARCHITECTS -
NEW JERSEY
BAYSHORE FAMILY OF COMPANIES
BRS, INC.
CHATFIELD GREEN ROOFING
CLEAN EARTH
CONNELL FOLEY LLP
DEWBERRY
DRESDNER ROBIN
EXCEL ENVIRONMENTAL
RESOURCES, INC.
GEI CONSULTANTS
GENOVA BURNS LLC
L2A LAND DESIGN, LLC
MIDATLANTIC ENGINEERING
PARTNERS, LLC
NEW JERSEY'S CLEAN
ENERGY PROGRAM
NEW JERSEY
REDEVELOPMENT AUTHORITY
PEAK ENVIRONMENTAL LLC
PS&S ARCHITECTS & ENGINEERING
SPATIAL DATA LOGIC
TIMOTHY HAAHS & ASSOCIATES, INC.

PANEL SESSION

EDISON PROPERTIES
INSITE ENGINEERING, LLC
M&T BANK
MASER CONSULTING P. A.
NISHUANE GROUP, LLC
NJM INSURANCE GROUP
RUSSO DEVELOPMENT
VALLEY NATIONAL BANK
VAN NOTE-HARVEY ASSOCIATES, INC.
WOODMONT PROPERTIES

COLLEAGUES

ADVANCE REALTY INVESTORS
AVALONBAY COMMUNITIES INC.
BORDEN PERLMAN
CME ASSOCIATES
H2M ARCHITECTS + ENGINEERS
INTEGRA REALTY RESOURCES -
NORTHERN NEW JERSEY
LRK
MINNO & WASKO ARCHITECTS
AND PLANNERS
NAIOP - NEW JERSEY
NEW JERSEY COMMUNITY CAPITAL
PHILLIPS PREISS GRYGIEL
LEHENY HUGHES LLC
SHARBELL DEVELOPMENT CORP.
SILLS CUMMIS & GROSS P.C.
SILVERMAN
TONIO BURGOS AND ASSOCIATES
WINDELS MARX LANE
& MITTENDORF LLP
WSP USA

VISIT OUR EXHIBITORS IN THE ATRIUM!

A postcard (available at registration) lists all of the exhibitors. Collect signatures from at least 10 exhibitors and bring your card to the registration table before 4:00 pm. You'll be entered into a drawing to win a New Jersey Future gift bag, including a \$50 gift card! Winners will be announced during the networking reception in the Atrium at 4:00 pm. *Must be present to win.*

AMERICAN INSTITUTE OF ARCHITECTS - NEW JERSEY

BAYSHORE FAMILY OF COMPANIES

BRS, INC.

CHATFIELD GREEN ROOFING

CLEAN EARTH

CONNELL FOLEY LLP

DEWBERRY

DRESDNER ROBIN

EXCEL ENVIRONMENTAL RESOURCES, INC.

GEI CONSULTANTS

GENOVA BURNS LLC

L2A LAND DESIGN, LLC

MARAZITI FALCON LLP

MIDATLANTIC ENGINEERING PARTNERS, LLC

NEW JERSEY FUTURE

NEW JERSEY HOUSING & MORTGAGE FINANCE AGENCY

NEW JERSEY NATURAL GAS

NEW JERSEY REDEVELOPMENT AUTHORITY

NEW JERSEY'S CLEAN ENERGY PROGRAM

PEAK ENVIRONMENTAL LLC

PENNONI

PS&S ARCHITECTS & ENGINEERING

PSEG

SPATIAL DATA LOGIC

TIMOTHY HAAHS & ASSOCIATES, INC.

BOARD OF TRUSTEES

PETER S. REINHART ESQ. Chair

Kislak Real Estate Institute
Monmouth University

KATHLEEN ELLIS Vice Chair

Kathleen Ellis Strategic
Solutions LLC

MEISHKA MITCHELL Secretary

Cooper's Ferry Partnership

HENRY A. COLEMAN PH.D. Treasurer

Edward J. Bloustein School
of Planning & Public Policy,
Rutgers University

WILLIAM E. BEST PNC Bank

JAY BIGGINS

Biggins Lacy Shapiro
& Company, LLC

LAUREN BOLES E4Progress City Planning and Engineering

AMY CRADIC New Jersey Resources

LAWRENCE DIVIETRO JR. Land Dimensions Engineering

JAMES GILBERT Merrill Lynch (retired)

AISHA GLOVER Newark Alliance

ROBERT GOLDSMITH ESQ. Greenbaum, Rowe, Smith & Davis LLP

ANDREW HENDRY First Energy/JCPL

JANE KENNY The Whitman Strategy Group

SUSAN S. LEDERMAN PH.D. Kean University (emerita)

JOSE LOZANO Choose New Jersey

JOSEPH MARAZITI JR. ESQ. Maraziti Falcon LLP

MARK MAURIELLO Edgewood Properties

COURTNEY MCCORMICK PSEG

GUALBERTO (GIL) MEDINA CBRE Brokerage Services

DAVID MOORE New Jersey Conservation Foundation (retired)

PAMELA MOUNT Terhune Orchards

INGRID REED Rutgers University (retired)

WANDA SAEZ Wells Fargo

STEPHEN SANTOLA ESQ. Woodmont Properties

BRIAN TRELSTAD Bridges Ventures

JENNIFER VELEZ RWJBarnabas Health

LEE WASMAN Atlantic City Electric

STEVEN WEINSTEIN ESQ. Rowan University

STAFF

PETER KASABACH Executive Director

LAUREN BELSKY Program Coordinator

GARY BRUNE Policy Manager

BRIANNE CALLAHAN Policy and Research Center Coordinator

ED DIFIGLIA Program Manager

TIM EVANS Director of Research

MICHELE GLASSBURG Director of Development and Outreach

MARIANNE JANN Manager of Finance and Administration

MO KINBERG Community Outreach Manager

DAVID KUTNER Senior Adviser

JULIA MCBRIDE Program Assistant

LOANA MENDEZ-SOLANO Communications and Development Assistant

KANDYCE PERRY Planning and Policy Manager

MISSY REBOVICH Director of Government and Public Affairs

TANYA ROHRBACH Community Planning Manager

CHRIS STURM Managing Director, Policy and Water

JYOTI VENKETRAMAN Program Manager

LOUISE WILSON Director, Green Infrastructure

SPONSORS

TITLE

Bank of America



PSEG

PROMOTIONAL BAG

MARAZITI FALCON, LLP

LUNCHEON and KEYNOTE

RWJBARNABAS HEALTH
NEW JERSEY NATURAL GAS

BREAKFAST and PLENARY

HACKENSACK MERIDIAN HEALTH
PENNONI
PNC BANK
THE COMMUNITY PRESERVATION CORPORATION

TRACK

NEW JERSEY ECONOMIC DEVELOPMENT AUTHORITY
RIKER DANZIG SCHERER HYLAND & PERRETTI LLP
SCARINCI HOLLENBECK, LLC
WILENTZ, GOLDMAN & SPITZER, P.A.

TECHNOLOGY

ATLANTIC CITY ELECTRIC, AN EXELON COMPANY
HLW
HUGO NEU CORPORATION
NEW BRUNSWICK CITY CENTER
ROBERT WOOD JOHNSON FOUNDATION

RECEPTION

FIRST ENERGY FOUNDATION/JERSEY CENTRAL POWER & LIGHT
GREENBAUM, ROWE, SMITH & DAVIS LLP
NEW JERSEY HOUSING AND MORTGAGE FINANCE AGENCY
NEXUS PROPERTIES



Wireless Access:

Network: @Hyatt_Meeting Username: njforum20 Password: njforum20

#njforum20